

Blindtex Custom Shutter Specification				
Code	ERSH-001	MDF	Page	1 / 12
Edition	G		Compiler	
Effective Date	2017/07/11		Reviewer	

## 1. Components:

### **Frame:**

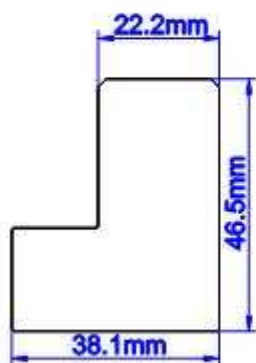

**Chamfer L Frame 46mm**

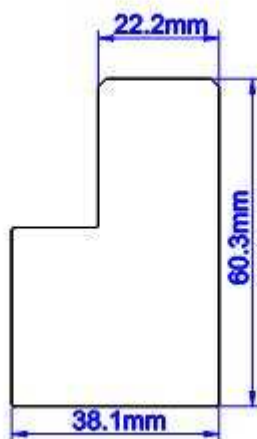

**Chamfer L Frame 60mm**

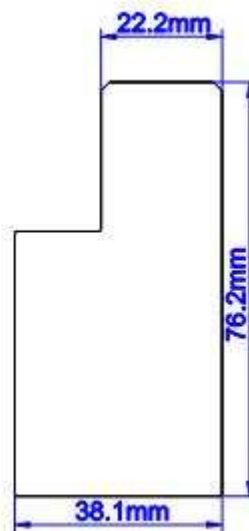

**Chamfer L Frame 76mm**

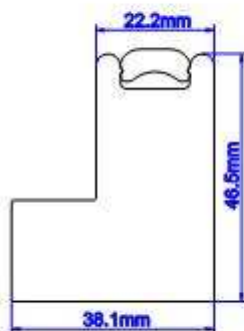

**Vintage L Frame 46mm**

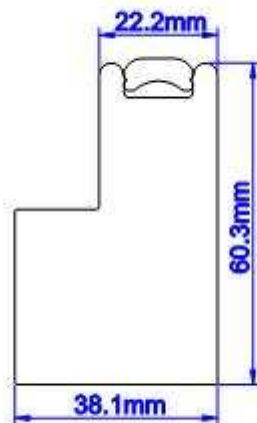

**Vintage L Frame 60mm**

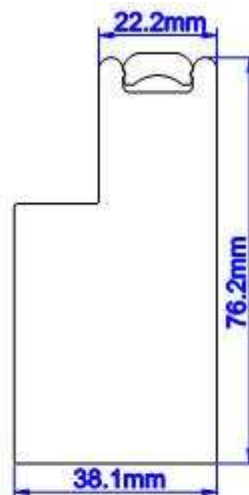

**Vintage L Frame 76mm**

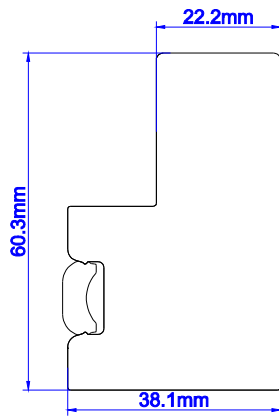

**Deep Plain L Frame 60mm**

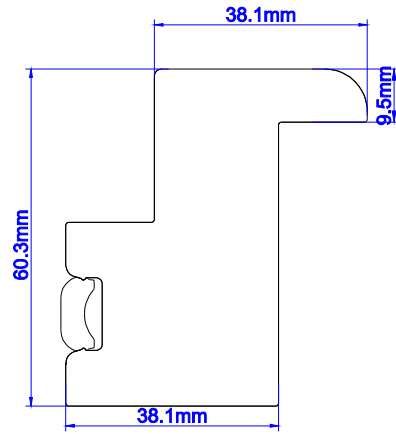

**Deep Bullnose Z Frame 38mm**

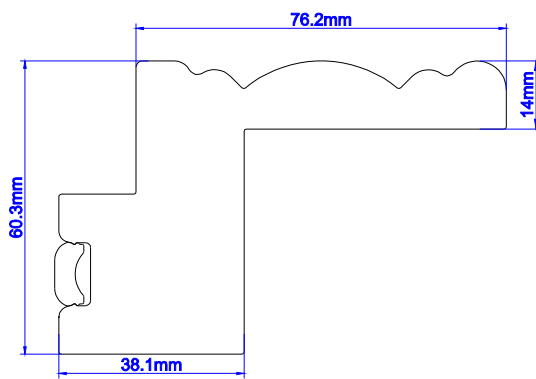

**Deep Crown Z Frame 76mm**

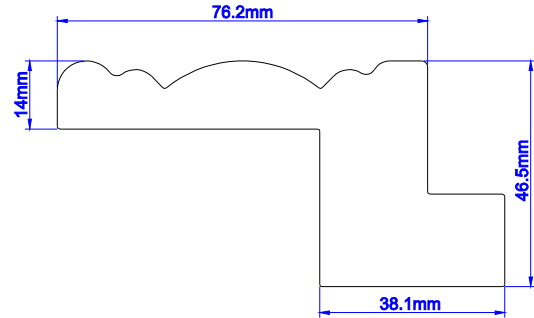

**Crown Z Frame 76mm**

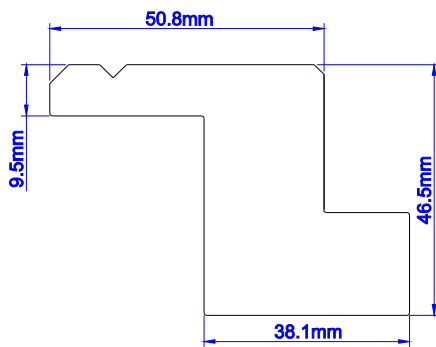

**Serrate Z Frame 50mm**

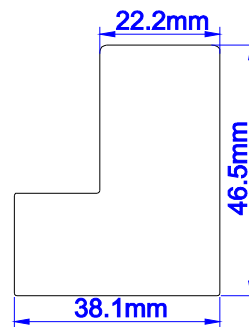

**Serrate Z Sill Plate**

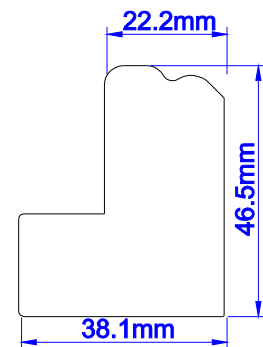

**Crown Z Sill Plate**

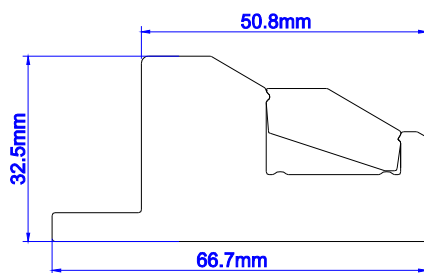

**Valley Deco Frame 50mm**

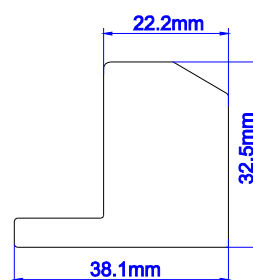

**Valley Deco Sill Plate**

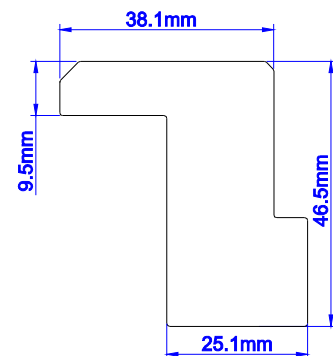

**Chamfer Z Frame 38mm**

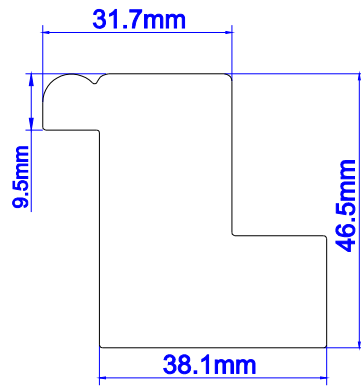

**Beaded Z Frame 31mm**

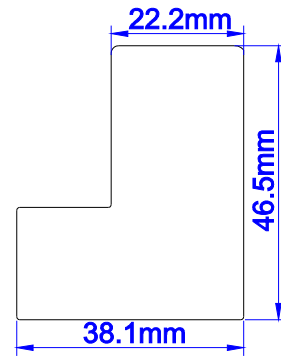

**Beaded Z Sill Plate**

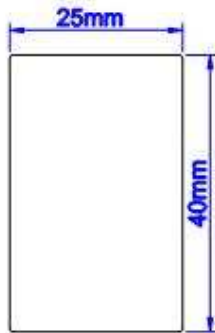

**Hang Strip 40mm**

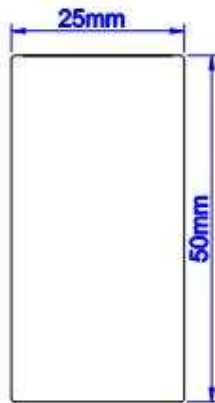

**Hang Strip 50mm**

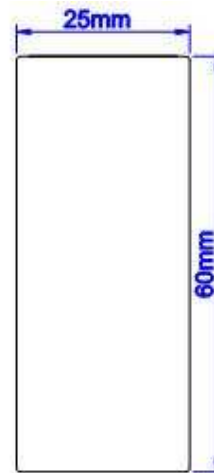

**Hang Strip 60mm**

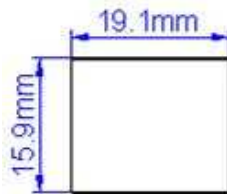

**Light Block**

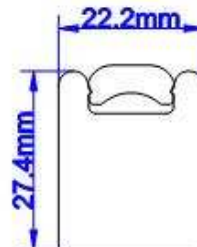

**Vintage Hang Strip**

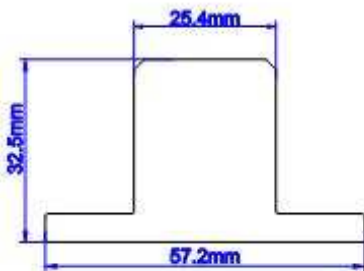

**Chamfer T Post (Deco)**

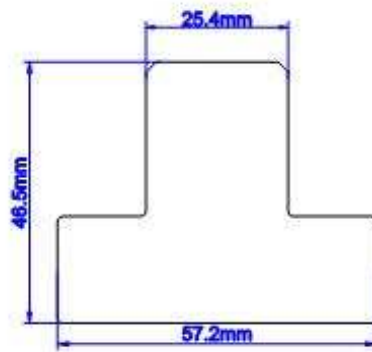

**Chamfer T Post (L/Z/HS)**

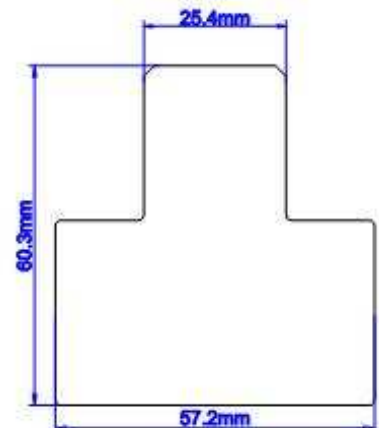

**Chamfer T Post 60mm**

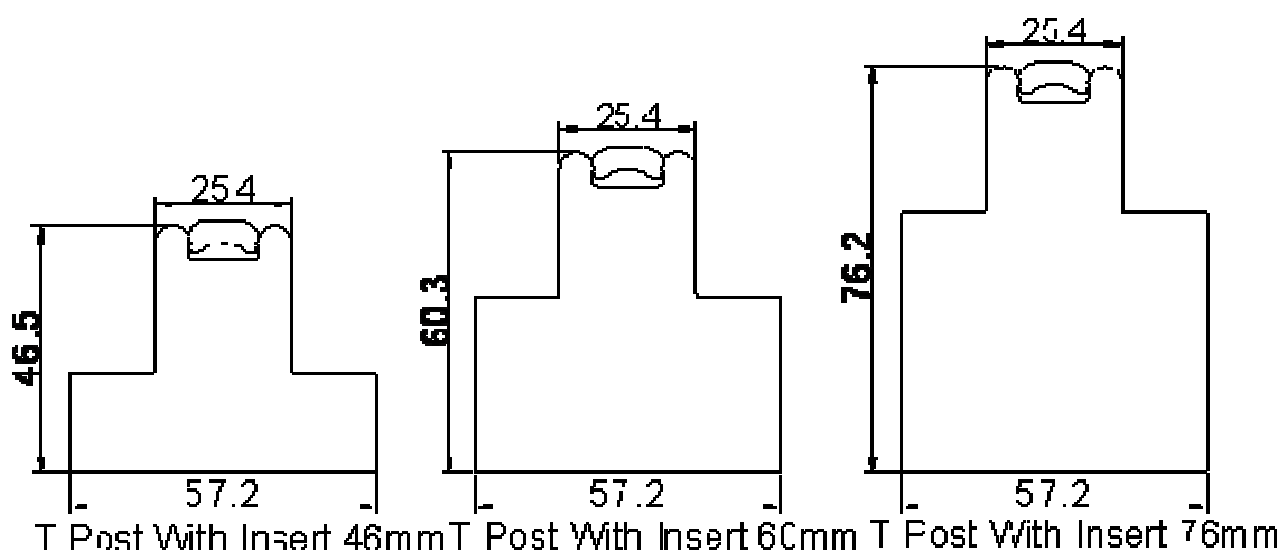

### **Extension for Z Frame:**

If you want the timber to be added to bottom of Z frame like the drawing on the right, please ALWAYS specify in the special note of the order form, “Add extension to light block section”. The DEFAULT EXTENSION will be the left drawing.

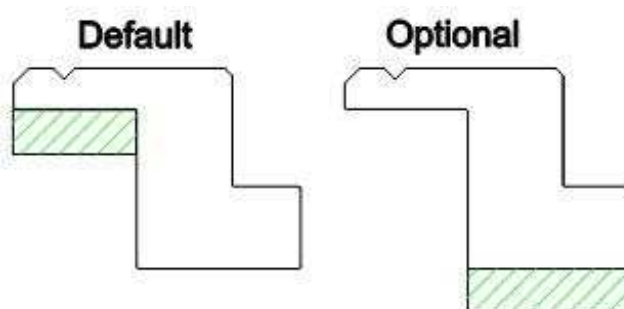

### **Battens:**

Standard size:

Coated with PP	Coated with PP	Made of wood
25mm x 19mm	5mm x 38mm	21mm x 21mm
25mm x 30mm	10mm x 38mm	27mm x 2.5mm
25mm x 40mm	15mm x 38mm	63.5mm x 5mm
25mm x 50mm	20mm x 38mm	19mm x 19mm
25mm x 60mm	25mm x 38mm	
25mm x 75mm	30mm x 38mm	
62mm x 11.5mm	35mm x 38mm	
	40mm x 38mm	

The other size battens are made of **wood**, paint to match colour with panel.

### **Stile:**

Butt Stile: Usually used on the side of panel that is hinged to batten or frame.

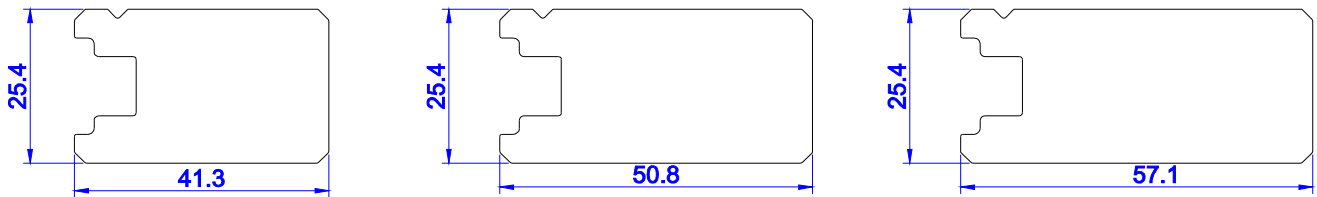

Rabbet Stile: Used on bi-fold panels or where 2 panels meet.

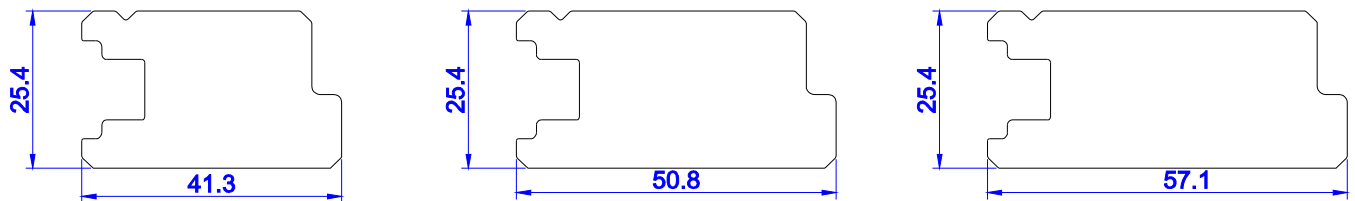

Chamfer Astragal Stile: used when 2 panels meet.

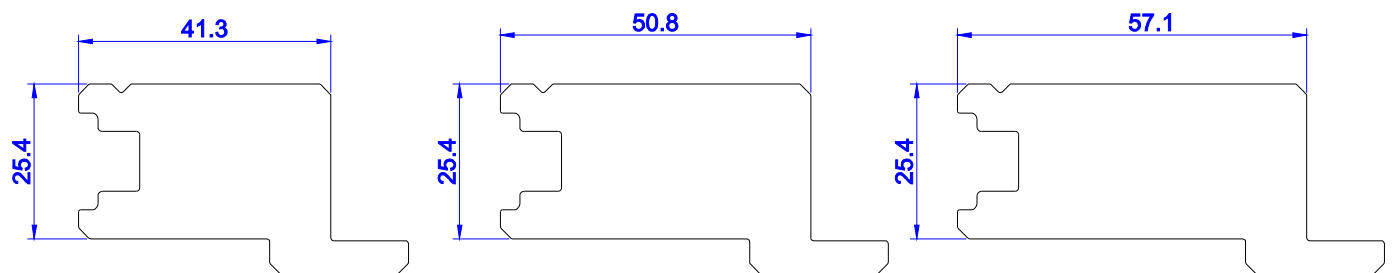

### **Rails:**

**Top & bottom rail:** Usually the Top & Bottom rail will larger than 80mm, Factory will decide the size, unless otherwise specified in the special instruction section of order form. The top and bottom rail will be the similar size if there is no divider rail. If need different rail size, please specify on special note. It is suggested ordering shutters for the same order at one time, so that the rail size will match.



**Divider rail:** Standard divider rail is 76.2mm

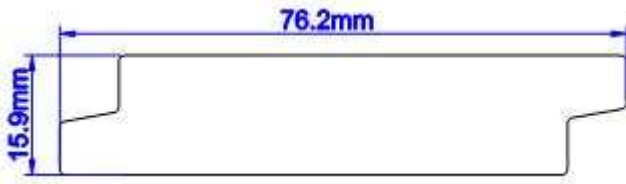

**Louvers:**



47mm Elliptical Louvre



63mm Elliptical Louvre



89mm Elliptical Louvre



114mm Elliptical Louvre

**Tilt rod:**

**1) Standard Tilt Rod:**

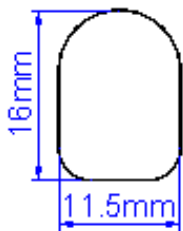

**2) Offset Tilt Rod:** Tilt rod can be ordered offset from centre. Please specify the position from the centre of the tilt rod to the end of the louvre. The standard distance for the offset tilt rod is 25mm to the end of the louvre on hinge side.

**3) Easy Tilt:** Only available for 63mm, 89mm and 114mm louvres.

Number of louvers exceeds the following will have separate gear tilt control:

Louvre Size	Louvre Qty
63mm	24
89mm	16
114mm	12

If the louver qty exceeds the above limit, the gear tilt control will be equally split into halves. If the louver qty is odd, will make the bottom section one more louver than the top section. If the panel has a divider rail, and the louver qty above divider rail or below divider rail exceeds above limited, split tilt rods are also required.

### \*\*\* Tilt rod position for multi-fold Top Track shutters:

For the multi-fold panels, we will make the tilt rod offset from the centre. By doing so, panels can be folded flat without tilt rods being obstructed with each other. The standard offset for the tilt rod is 7mm from the centre, i.e. tilt rod will be 7mm to the left from the centre for the left panels, and 7mm to the right from the centre for the right panels. The rabbet is made with right panels over left ones for the both the panels folded to left and to right.

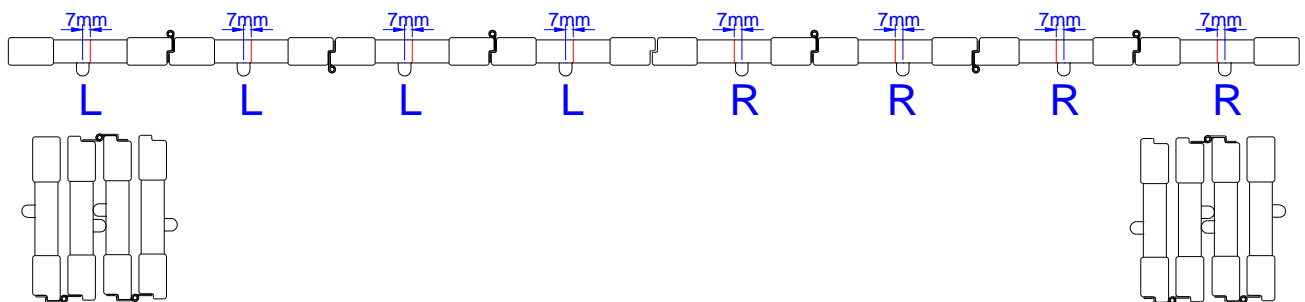

For the 2 panels and 4 panels configuration (LLRR), tilt rod in centre of panel, no need to offset.

\*\*\* Multi-fold panel config is not suggested and not under warranty. Only Multi-fold panels with top and bottom track for Bifold track system is under warranty.

## 2. Louver Pin:

Louvre pins are used to ensure louvre tension. Additionally a tension rod is inserted through a louvre in the panel. This will require the panel to have holes in the stiles for the screw caps of the tension rod. The tension can be adjusted by tightening or loosening the screw caps.

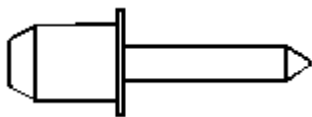

## 3. Colour Options:

Shutter Colour	Hinge Colour	
	Default Colour	Optional Colour
001 Pure White	Pure White	1.Bright Brass
003 Silk white	White	2.Anti-Brass
004 Bright White		3.Stainless Steel
006 Pearl	Pearl	4. Nickel-Plated
009 Creamy	Bisque	5.Brushed Nickel Plated

Please order shutters for the same home at one time. Slight variations may also occur between the finished products and the colour decks

#### 4. Panel size limitation:

Louver size	Width			Height		
	Min.	Max.		Min.	Max	Mid rail Required if
		Single Hung	Bi-fold hinged shutter/ Multi-fold with top&bottom track			
47mm	152mm	600mm	600mm	250mm	3000mm	H>1879mm
63mm	152mm	750mm		250mm	3000mm	H>1879mm
89mm	152mm	750mm		250mm	3000mm	H>1879mm
114mm	152mm	750mm		250mm	3000mm	H>1879mm

If panel size is out of spec, on hold query will be sent for confirm instead of waving warranty automatically.

If panel height is over 1879mm, a divider rail is required. And if the panel has a divider rail but the height from center of divider rail to top of the top rail or to bottom of bottom is still over 1879mm, another divider rail is required. If you do not specify the divider rail location, we will hold the order to confirm if a divider rail is required.

#### 5. Shutter used for door without bottom support:

In situations when shutters are used for door application, which do not have support underneath the panels, the customers must inform NienMade when placing the type of order.

Please note:

- (1) The factory will add extra hinges to support the panels.
- (2) Bigger and Stronger Top and Bottom rail. This will reduce the probability of the panels sagging and increase shutter intensity.

If customer fail to notify NienMade that the shutter will be used in door application and consequently, the customer will be responsible for the cost of the any RGA Reorder that is submitted.

Please see the following chart for details.

Panel Configuration	
L, R, LR	LL, RR, LLRR
Manufacture with warranty waived.	Must order with track.



## 6. Panel configuration:

**Rabbit Stile:** if choose rabbit stile on the order form, then the panels will be made like the following drawings.

1 Panel: L or R



2 Panels: LL/RR/LR

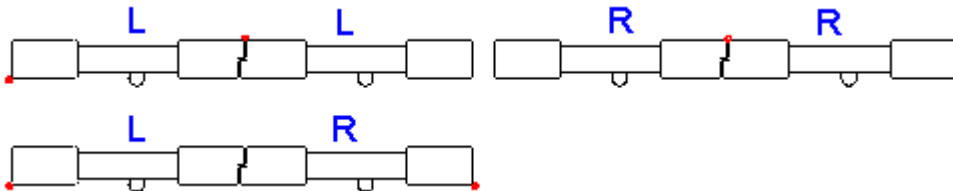

3 Panels: LLR/LRR

**For LRR, L panel will be open first.**

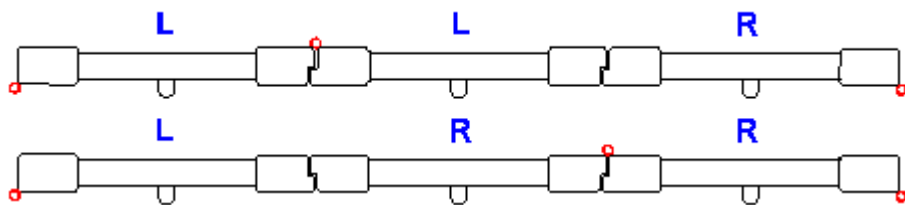

4 Panels: LLRR

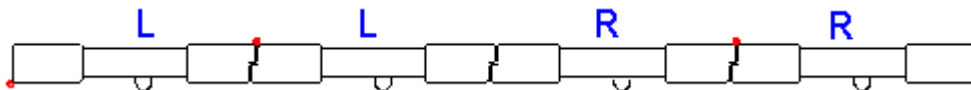

**Astragal Stile:** If choose astragal stile in the order form, then panels will be made like the following drawings.

1 Panel L or R: (both side to be butt stile)



2 Panels:

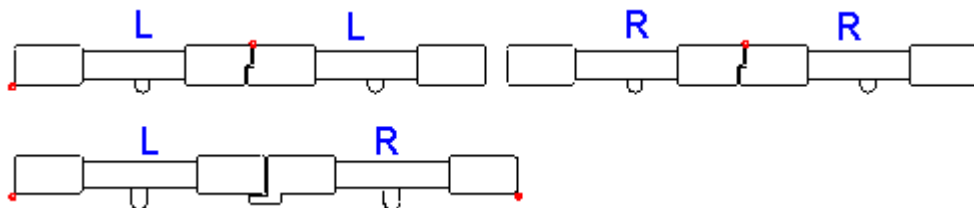

**3 panels: for LRR, L panel will be opened first.**

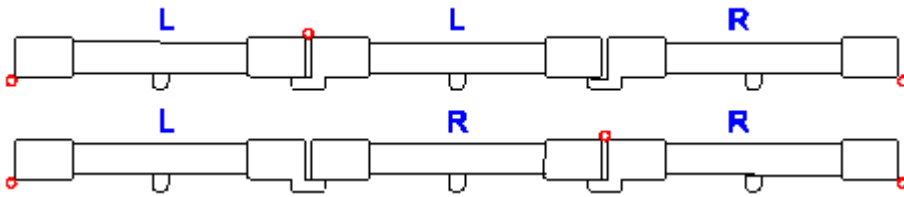

**4 panels:**



**6 panels or more:** will be made like the following, astragal stile is only used where 2 panels meet without hinges.

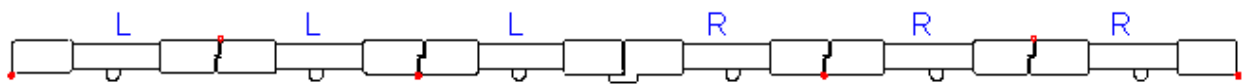

Please specify the panel fold configuration on order form, we will pre-hinge according to it.

## 7. Mounting Type:

**Café Shutter:** Please specify on the order form if the shutter is a café style. We will finish the top of the panels and the end of battens.

**Tier on Tier:** Please specify the height of the bottom tier.

**Full height:** regular shutter in full height of window.

## 8. Order Size:

**Overall Panel Size:** Size given is overall panel size, width is not includes the hinge space that from panel to batten on the left & right side, but includes the gap between panels. The height given must be net panel height. The hinges and magnets will be pre-installed to panel.

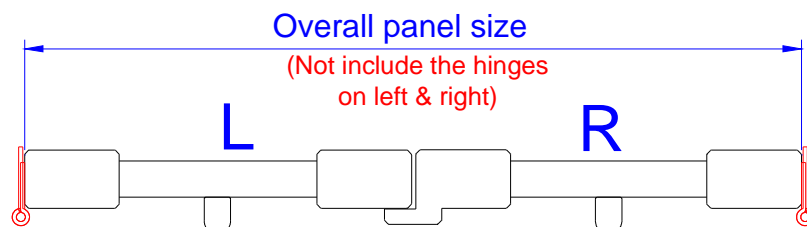

**OD of frame Size:** Size given is outside dimension of the shutter frames, width is from left edge of left frame to right edge of right frame; height is measured from top of top frame to bottom of bottom frame.

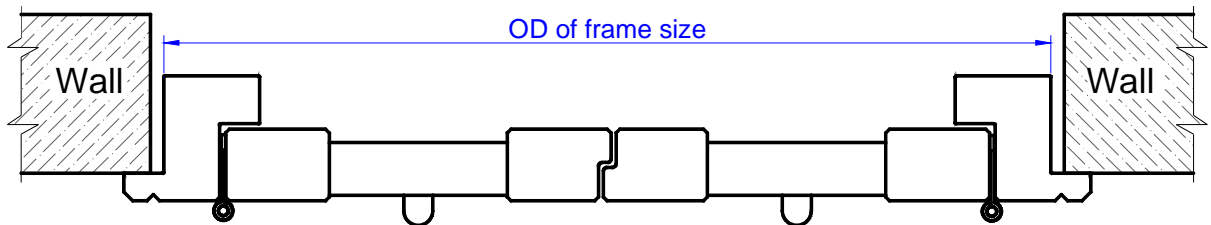
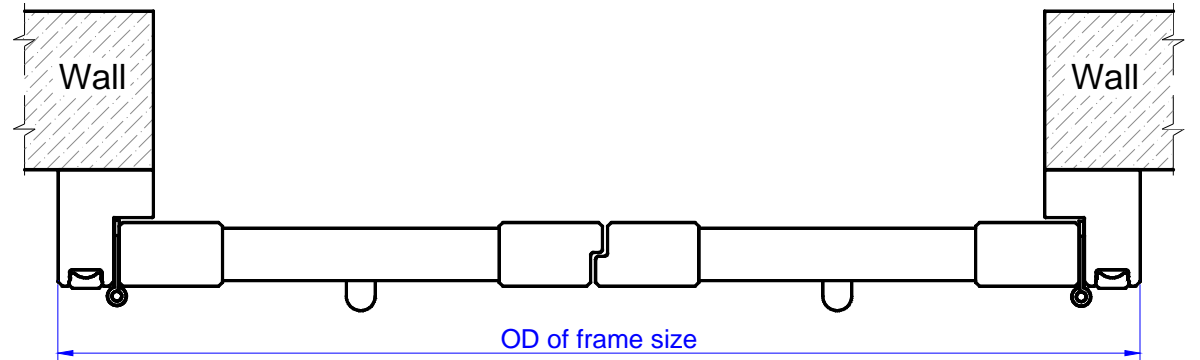
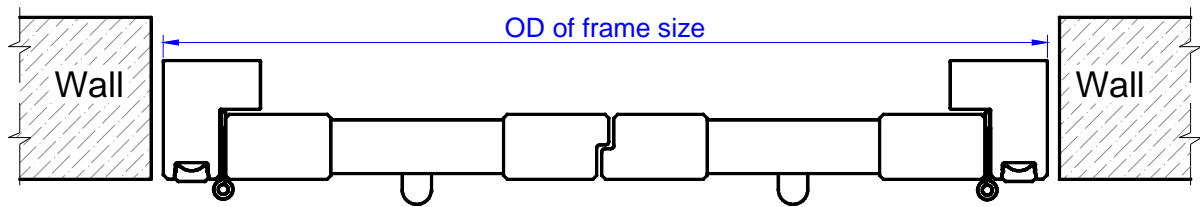

*For Z frame, the size is measured from backside of the frame, not from the front lip.*

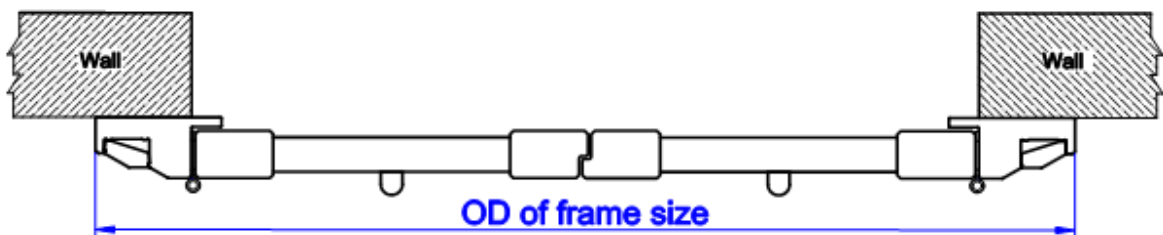
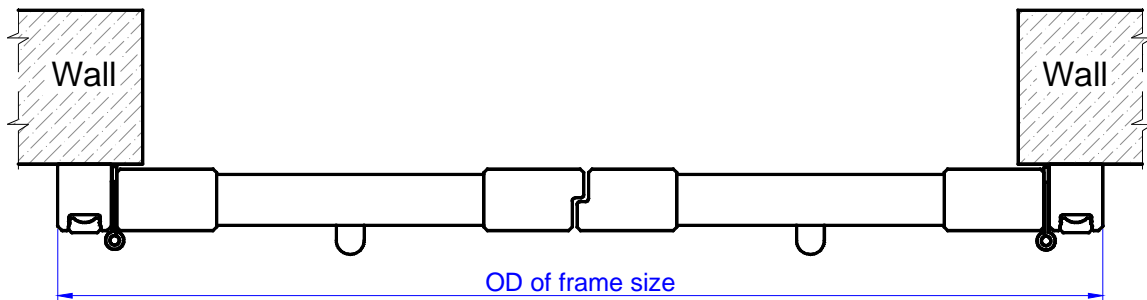

9. **Specialty:** Only available in rake, triangle, octagon and hexagon.

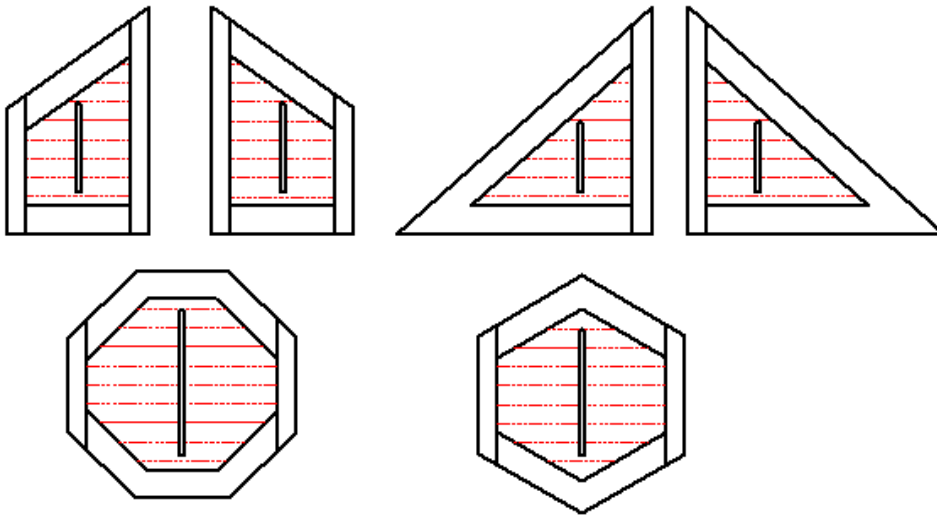

## 10. Tolerance:

**Width:** The width of the shutter can be plus or minus 1.6mm from the order width.

**Height:** The height of the shutter can be plus or minus 1.6mm from the order height.

**Divider rail location:** Divider rail location may be off by half a louvre space:

For 47mm louvre can be off by +/-19mm.

For 63mm louvre can be off by +/-25mm.

For 89mm louvre can be off by +/-38mm.

For 114mm louvre can be off by +/-51mm.

11. The standard gap at top and bottom of the panel and frame is 5mm when shutter is two sides.

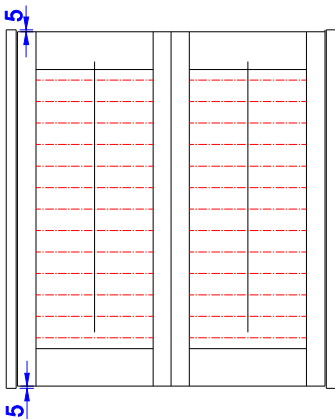

## 12. Cancellation:

Since NienMade China custom manufactures products based on the specifications you provided on the original order form, no cancellations will be accepted. Once the order is submitted, the customer will be liable for the full amount of the shutter order.

### 13. Warranty:

- \*The Color Fastness is warranted for 3 years.
- \*Workmanship is warranted for 3 years.
- \*Hardware is warranted for 1 year.
- \*Stainless Steel Hardware is warranted for 3 year.

### 14. Spare Louver:

Spare louvers 2per pack: For one item with uneven panel width, we will supply 2 louvers for each width;

### 15. Default Stile for LRR configuration:

It is default to open L panel first when the configuration is LRR.

### 16. Extended Frame

For orders in which the frames or hang strips (L/R) are ordered to an extended length warrantee will only apply where the shutter panels are supported in the closed position. Any RGA claim for such orders must show photographic evidence of the supported panels in the closed position.

### 17. Frames split

When frames length (including shutter frames, battens, fascia, header and track for track system) exceed the below limitation, then the frames will be split as the below chart described. Please review the chart below for reference.

Shipping Method	Frame length (L) (mm)
Standard shipping	$3630 < L \leq 7260$ (2 sections) / $L > 7260$ (3 sections)
Airfreight	$3048 < L \leq 6096$ (2 sections) / $6096 < L \leq 9144$ (3 sections)

### Notes:

☆ No warranty for horizontal T post length exceeds 1219mm.

### 18. The Claim Limitation Date for Shipping Damage for Airfreight Orders:

For all airfreight orders with shipping damages, claims must be submitted within 1 week after the date of receipt.