

Blindtex Custom Shutter Specification				
Code	ERSH-003	Phoenixwood	Page	1 / 15
Edition	J		Compiler	
Effective Date	2017/07/11		Reviewer	

1. Components:

Frame options:

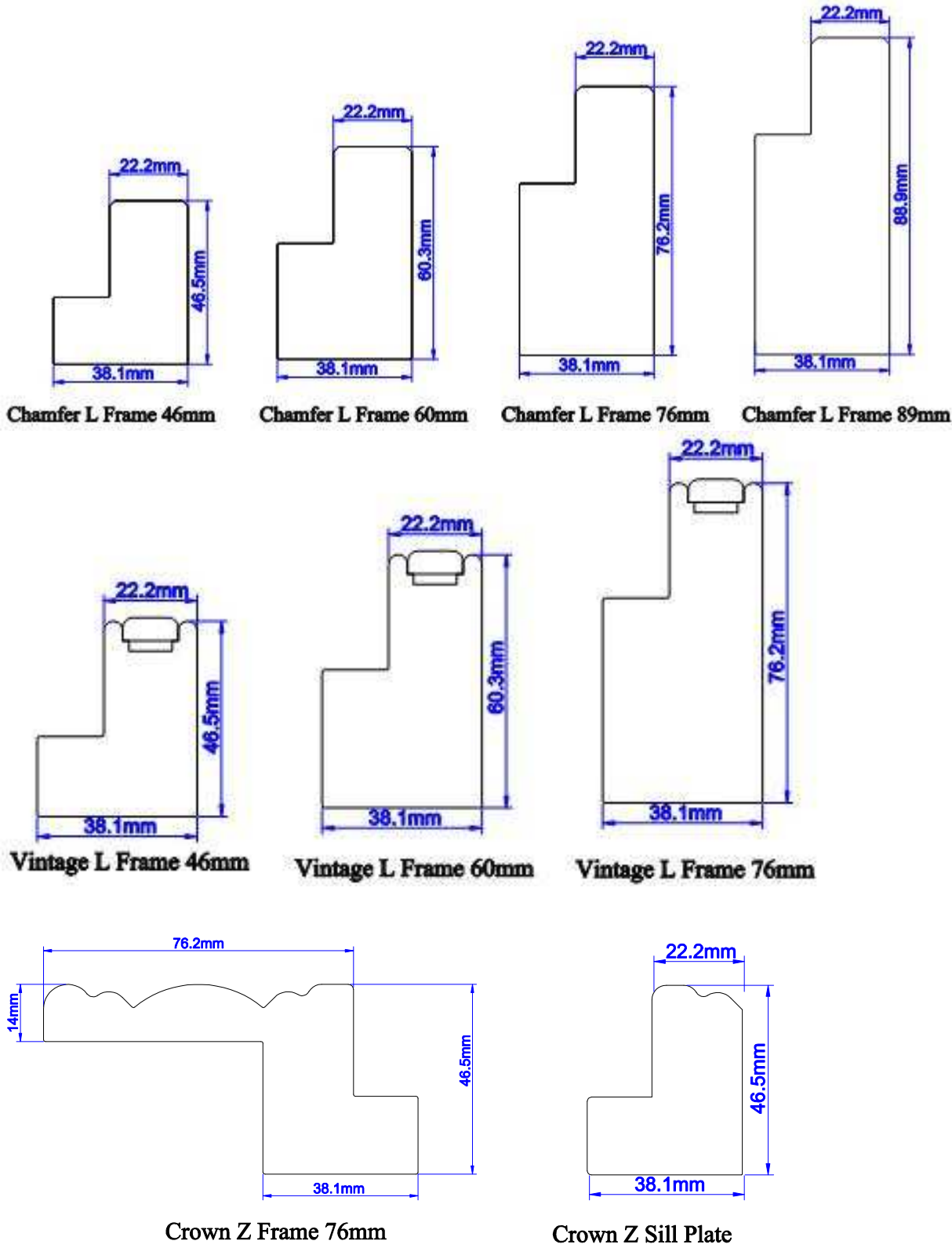

Blindtex Custom Shutter Specification				
Code	ERSH-003	Phoenixwood	Page	2 / 15
Edition	J		Compiler	
Effective Date	2017/07/11		Reviewer	

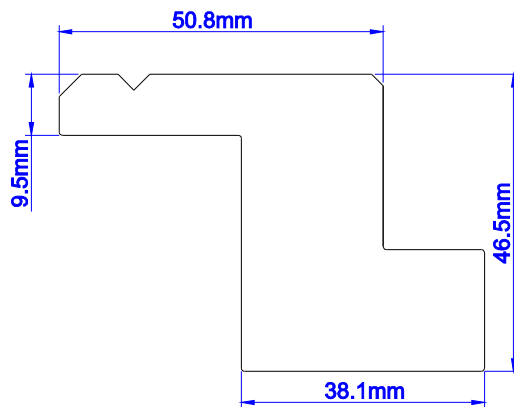

**Serrate Z Frame 50mm**

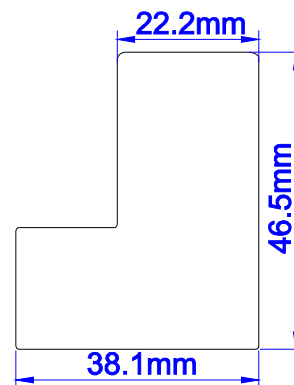

**Serrate Z Sill Plate**

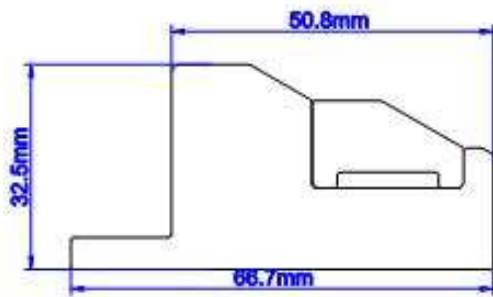

**Valley Deco Frame 50mm**

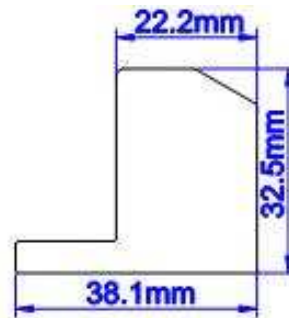

**Valley Deco Sill Plate**

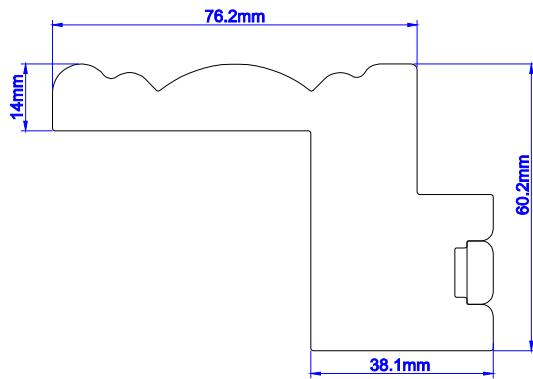

**Deep Crown Z Frame 76mm**

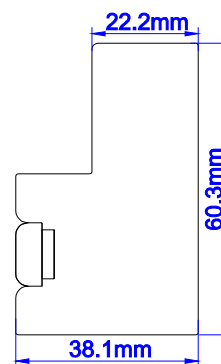

**Deep Plain L Frame 60mm**

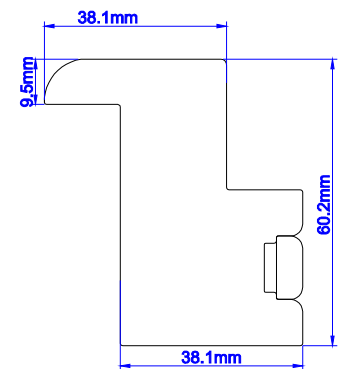

**Deep Bullnose Z Frame 38mm**

Blindtex Custom Shutter Specification				
Code	ERSH-003	Phoenixwood	Page	3 / 15
Edition	J		Compiler	
Effective Date	2017/07/11		Reviewer	

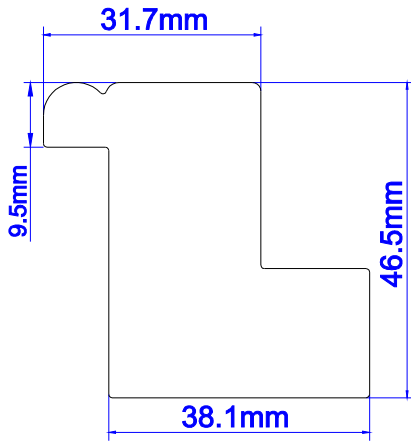

**Beaded Z Frame 31mm**

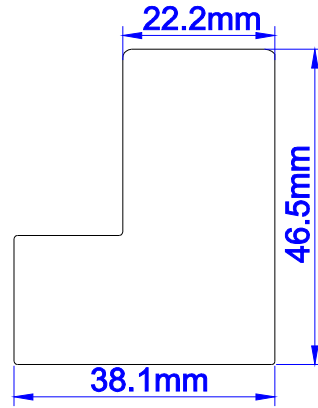

**Beaded Z Sill Plate**

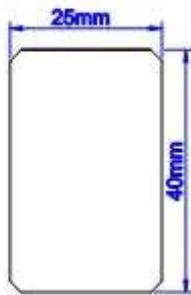

**Chamfer Hang Strip 40mm**

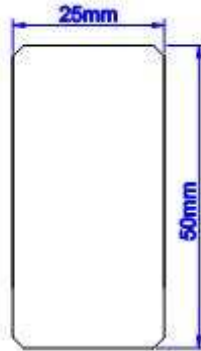

**Chamfer Hang Strip 50mm**

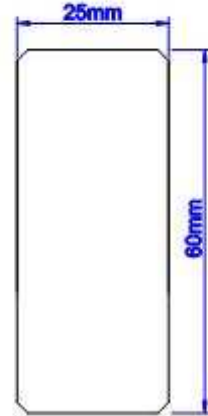

**Chamfer Hang Strip 60mm**

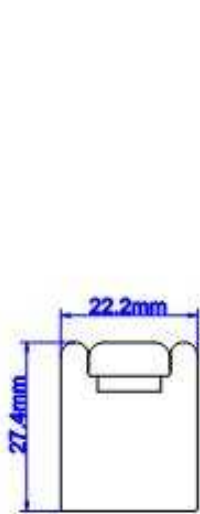

**Vintage Hang Strip 22mm**

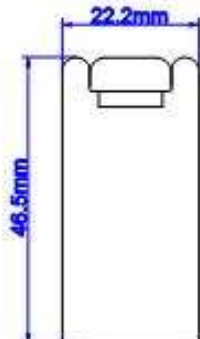

**Vintage Hang Strip 46mm**

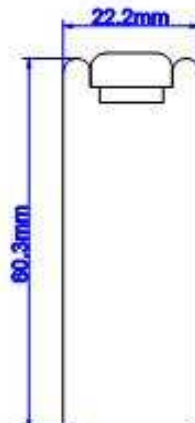

**Vintage Hang Strip 60mm**

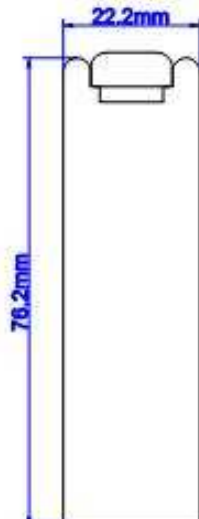

**Vintage Hang Strip 76mm**

Blindtex Custom Shutter Specification				
Code	ERSH-003	Phoenixwood	Page	4 / 15
Edition	J		Compiler	
Effective Date	2017/07/11		Reviewer	

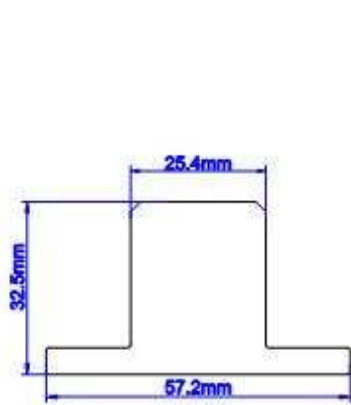

**Chamfer T Post (Deco)**

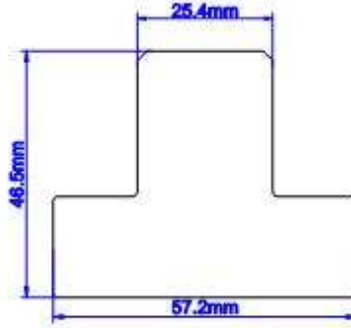

**Chamfer T Post (L/Z/HS)**

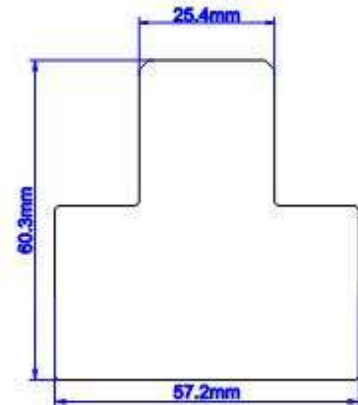

**Chamfer T Post 60mm**

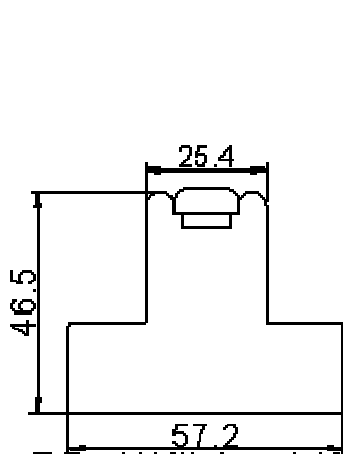

**T Post With Insert 46mm**

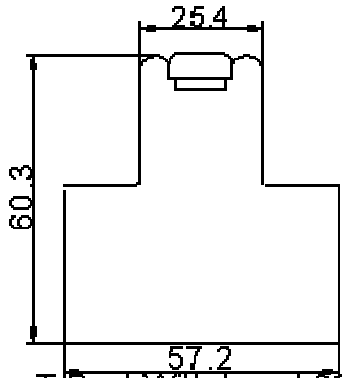

**T Post With Insert 60mm**

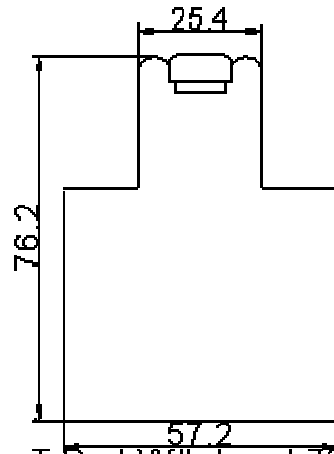

**T Post With Insert 76mm**

### ***Extension for Z Frame:***

If you want the timber to be added to bottom of Z frame like the drawing on the right, please ALWAYS specify in the special note of the order form, "Add extension to light block section". The DEFAULT EXTENSION will be the left drawing.

**Default**

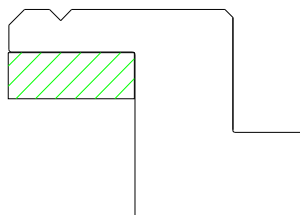

**Optional**

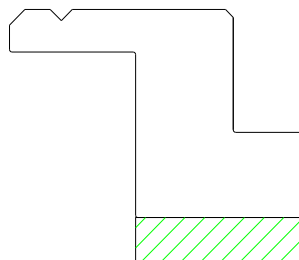

Blindtex Custom Shutter Specification				
Code	ERSH-003	Phoenixwood	Page	5 / 15
Edition	J		Compiler	
Effective Date	2017/07/11		Reviewer	

### Stile:

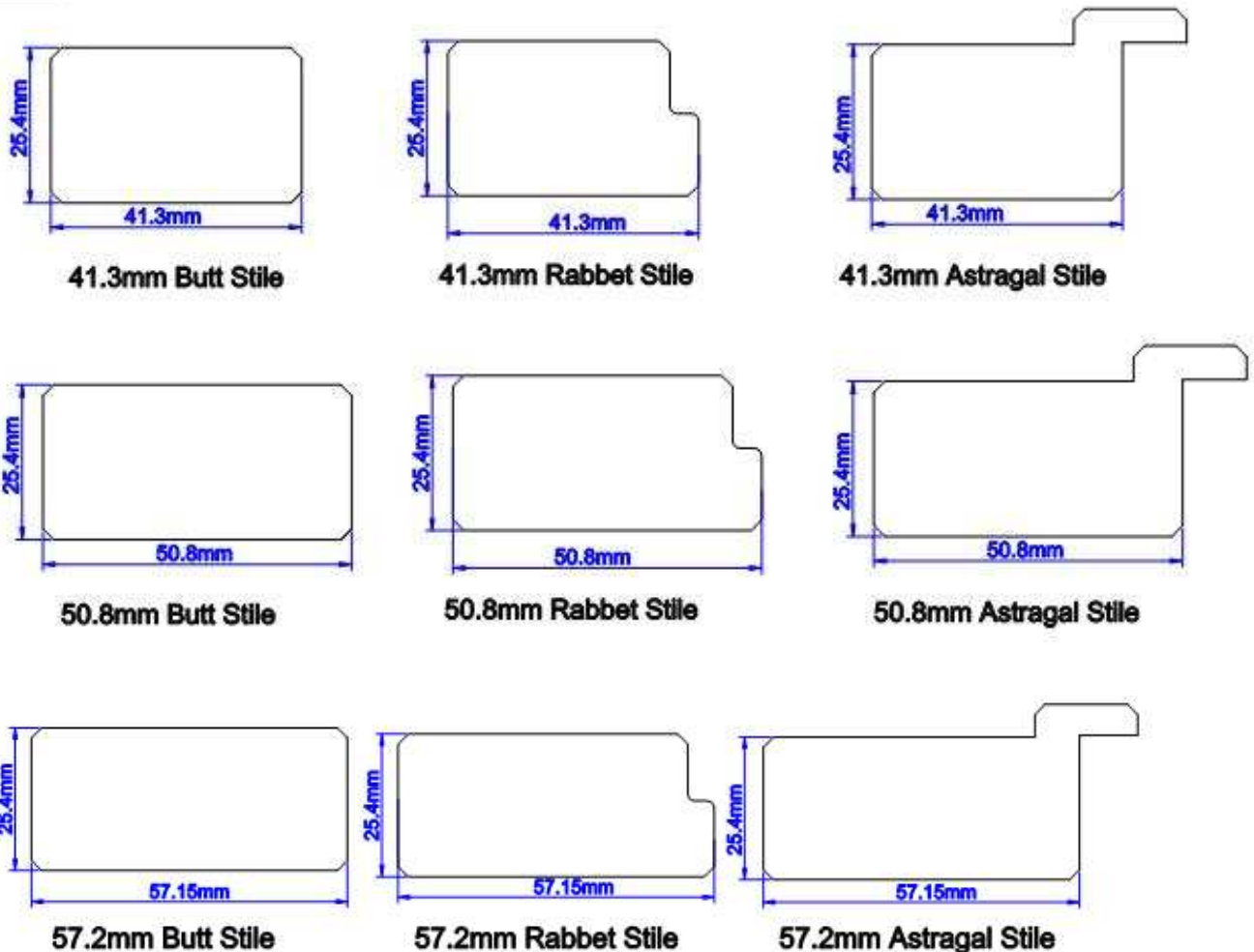

### Rails:

**Top & Bottom rail:** Usually the Top & Bottom rail will be larger than 80mm. Factory will decide the size, unless otherwise specified in the special instruction section on order form. The top and bottom rail will be the same size if there is no divider rail. If you need different size rails, please specify. We suggest ordering shutters for the same order at one time, so that the rail size will match.



Blindtex Custom Shutter Specification				
Code	ERSH-003	Phoenixwood	Page	6 / 15
Edition	J		Compiler	
Effective Date	2017/07/11		Reviewer	

**Divider rail:** Standard divider rail is 76.2mm.

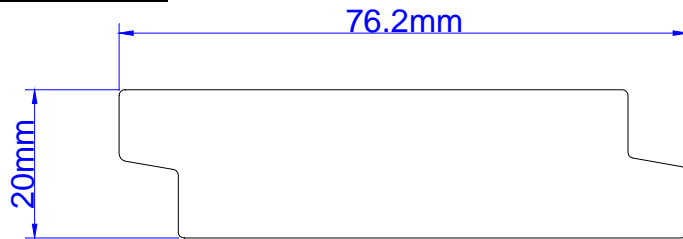

### **Louvers:**

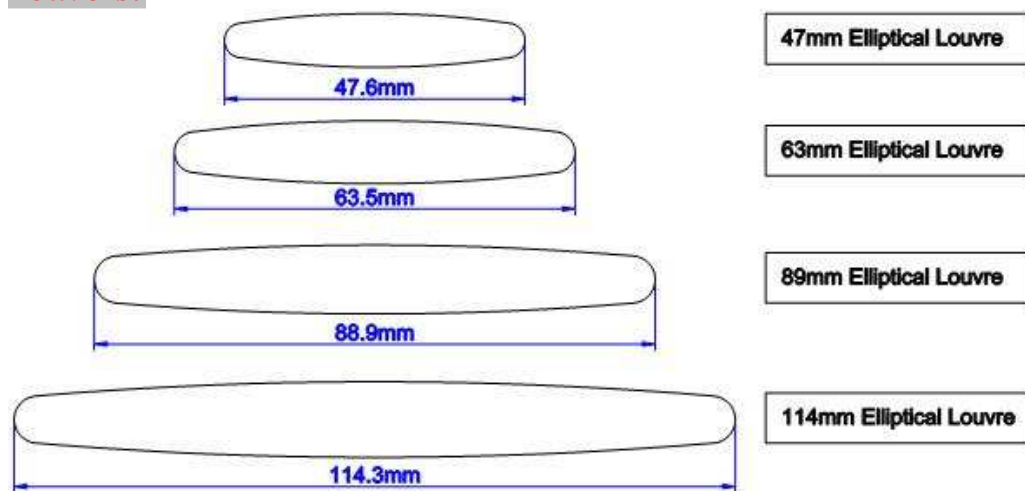

### **Tilt rod:**

1) Standard Tilt Rod:

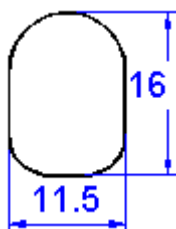

- 2) **Offset Tilt Rod:** Tilt rod can be ordered offset from centre. Please specify the position from the centre of the tilt rod to the end of the louver. The standard distance for an offset tilt rod is 25mm to the end of the louver on hinge side.
- 3) **Easy Tilt system:** The stile that holding the pinion gear & rack will have a groove and cover strip. Number of louvers exceeds the following will have separate gear tilt control:

Louvre Size	Louvre Qty
63mm	24
89mm	16
114mm	12

If the louver qty exceeds the above limit, the gear tilt control will be equally split into halves. If the louver qty is odd, will make the bottom section one more louver than the

Blindtex Custom Shutter Specification				
Code	ERSH-003	Phoenixwood	Page	7 / 15
Edition	J		Compiler	
Effective Date	2017/07/11		Reviewer	

top section. If the panel has a divider rail, and the louver qty above divider rail or below divider rail exceeds above limited, split tilt rods are also required.

### **Louver Pin:**

Louvre pins are used to ensure louver tension. Tension screw is inserted a louvre in the panel for all size of louvres. This will require the panel to have holes in the stiles for the screw. The louver tension can be adjusted by tightening or loosening the screw. So additional holes will be visible in the stiles.

There are 2 colours: white and brown, white for all paint colour shutters and brown for all stained shutters.



### **\*\*\*Offset tilt rod for multi-fold shutters:**

For the multi-fold panels, we will make the tilt rod offset from the centre. By doing so, panels can be folded flat without tilt rods being obstructed with each other. The standard offset for the tilt rod is 7mm from the centre, i.e. tilt rod will be 7mm to the left from the centre for the left panels, and 7mm to the right from the centre for the right panels. Besides, the rabbet is made with right panels over left ones for the both the panels folded to left and to right.

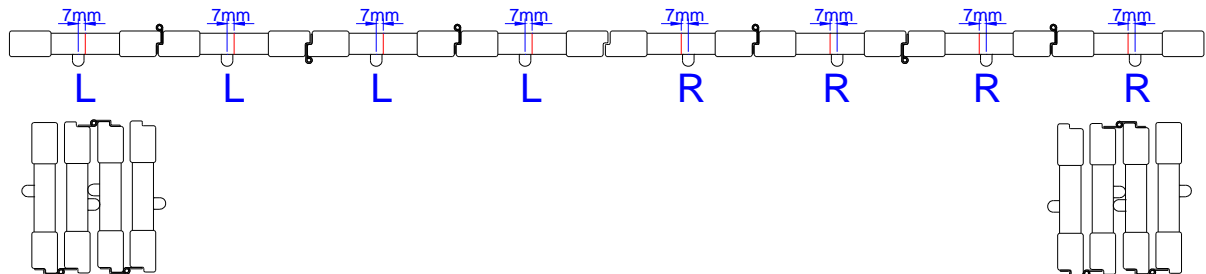

For 2 panels (LL/RR) and 4 panels configuration (LLRR), there is no need to offset the tilt rod.

### **Battens:**

Standard Size:

Made of Phoenixwood	
19mm x 19mm	25mm x 60mm
19mm x 25mm	25mm x 75mm
21mm x 21mm	27mm x 2.5mm
25mm x 30mm	62mm x 12mm
25mm x 40mm	63.5mm x 5mm
25mm x 50mm	

\* The Special shaped battens are available

Blindtex Custom Shutter Specification				
Code	ERSH-003	Phoenixwood	Page	8 / 15
Edition	J		Compiler	
Effective Date	2017/07/11		Reviewer	

## 2. Colour Options:

Total 50 colours: 21 paint colours and 29 stain colours.

Color ID	Color Name	Default Hinge Colour	Default Track Colour
001	Pure White	Pure White	White
003	Silk White	White	
004	Bright White		
006	Pearl	Pearl	
007	Ivory Lace		
008	Marshmallow		
009	Creamy	Bisque	
011	Cameo		
012	Crisp Linen		
013	Bisque		
016	Butter		
019	String		
030	Moondust	Nickel Plated	Anodised Silver
032	Sea Mist		
046	Ice	White	White
048	Chai	Nickel Plated	Anodised Silver
049	Stone Gray		
051	Brown Gray		
053	Clay		
063	Decorators White	White	White
836	Classic Black	Black	Anodised Silver
108	Rustic Gray	Nickel Plated	Anodised Silver
110	Limed White	White	White
114	Taupe	Nickel Plated	Anodised Silver
200	Natural	Antique Brass	Coffee
202	Golden Oak		
204	Oak Mantel		
205	Goldenrod		
206	Pecan		
211	Cherry		
212	Dark Teak		
214	Cocoa		
215	Cordovan		
219	Mahogany		
220	New Ebony		
221	Black Walnut		



Blindtex Custom Shutter Specification				
Code	ERSH-003	Phoenixwood	Page	9 / 15
Edition	J		Compiler	
Effective Date	2017/07/11		Reviewer	

227	Red Oak
229	Rich Walnut
230	Old Teak
231	Spring Rose
232	Red Mahogany
233	Dark Mahogany
237	Wenge
242	Auburn
247	Bark
248	Pretzel
249	Acorn
250	Sumatra
251	Raisin
252	Toffee

### OSMO Stain Colors: (with water-based paint)

NO.	Color ID	Color Name	Default Hinge Color	Default Track Color	Default Motor Color
1	1003	White Matt	White	White	White
2	1501	Oak	Antique Brass	Coffee	Caramel
3	1107	Oak Antique	Antique Brass	Coffee	Coffee
4	1502	Teak	Antique Brass	Coffee	Caramel
5	1301	Cherry	Nickel Plated	Anodised Silver	Caramel
6	1401	Mahogany	Antique Brass	Coffee	Coffee
7	1109	Silk Gray	Nickel Plated	Anodised Silver	Coffee
8	1111	Granite Gray	Antique Brass	Coffee	Coffee
9	1203	Black	Antique Brass	Coffee	Coffee
10	1204	Ebony	Antique Brass	Coffee	Coffee

#### ✧ What is OSMO?

The OSMO color is made from natural plant oil and vegetable wax, so it's free of harmful substances. It's a very safe paint.

Since OSMO color is permeable paint, which can prevent the degradation of the slats and present the exquisite grain of Normandy blind. It's a good-looking and health-friendly color series.

All of the OSMO colors are special stains that enhance the wood grain and therefore the final product may appear different than the samples due to natural variations found in wood.

#### ✧ Color Characters

- The pattern and hue cannot be specified;
- Due to permeability variation, there might be uneven paint;
- The color might vary with time;
- The wood grain and hue might be different in different order date. We suggest ordering the shutters in the same color and building at one time.

Optional Hinge color: Bright brass, Black, Stainless steel, Nickel-Plated, Brushed Nickel Plated

Blindtex Custom Shutter Specification				
Code	ERSH-003	Phoenixwood	Page	10 / 15
Edition	J		Compiler	
Effective Date	2017/07/11		Reviewer	

Due to the nature of material manufacturing, colours may vary slightly between dye lots. Please order shutters for the same home at one time. Slight variations may also occur between the finished products and the colour decks.

The 836 classic black have surcharge as custom color.  
Custom Colour is also available with extra charge.

### 3. Panel size limitation:

Louver size	Min.	Max.		
		Single Hung	Bi-fold hinged shutter/ Multi-fold with top&bottom track	Multi-fold hinged shutter/ Multi-fold with top track only
47mm	152mm	750mm	660mm	550mm (No. of panels≤4)
63mm	152mm	890mm		
89mm	152mm	1047mm		
114mm	152mm	1047mm		

If panel size is out of spec, on hold query will be sent for confirm instead of waving warranty automatically.

If panel height is over 1981mm, a divider rail is required. And if the panel has a divider rail but the height from center of divider rail to top of the top rail or to bottom of bottom is still 1981mm, another divider rail is required. If you do not specify the divider rail location, we will hold the order to confirm if a divider rail is required. But if specify no divider rail, we will regard it as you have waived your warranty.

\*For circle and oval shape, if the panel width exceeds the size limit above, making with center stile is not available and it is suggested to change the panel configuration to RTL. However, if panel width is within spec, it can be made with center stile.

### 5. Shutter used for door without bottom support:

In situations when shutters are used for door application, which do not have support underneath the panels, the customers must inform NienMade when placing the type of order. Please note:

- (1) The factory will add extra hinges to support the panels.
- (2) Bigger and Stronger Top and Bottom rail. This will reduce the probability of the panels sagging and increase shutter intensity.

\* If customers fail to notify NienMade that the shutter will be used in door application and consequently, the customers will be responsible for the cost of the any RGA Reorder that is submitted.

Please see the following chart for details.

Blindtex Custom Shutter Specification				
Code	ERSH-003	Phoenixwood	Page	11 / 15
Edition	J		Compiler	
Effective Date	2017/07/11		Reviewer	

Panel Configuration	
L, R, LR	LL, RR, LLRR
Within warranty.	Must order it with track or waive warranty.

## 6. Panel configuration:

**Rabbit Stile:** if choose rabbit stile on the order form, then the panels will be made like the following drawings.

1 Panel: L or R

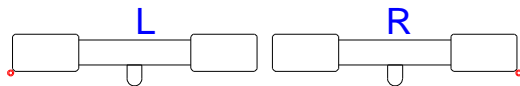

2 Panels: LL/RR/LR

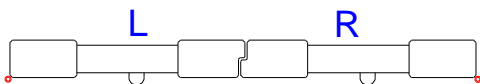

3 Panels: LLR/LRR For LRR, L panel will be open first.

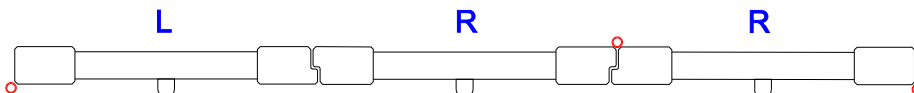
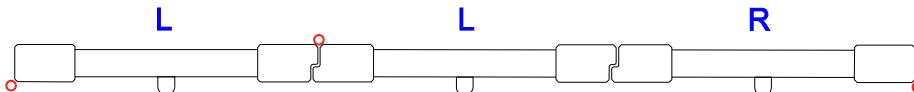

4 Panels: LLRR

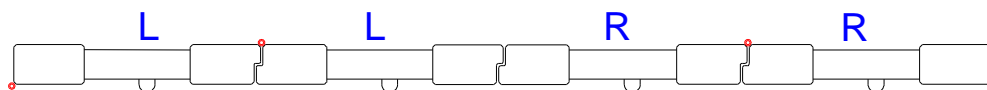

**Astragal Stile:** If choose astragal stile in the order form, then panels will be made like the following drawings.

1 Panel L or R: (both side to be butt stile)

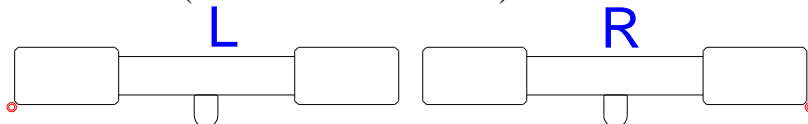

2 Panels:

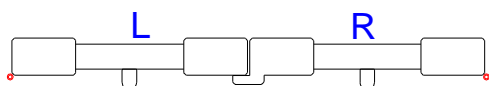
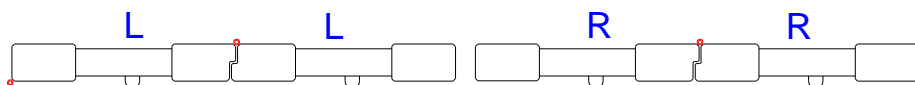

Blindtex Custom Shutter Specification				
Code	ERSH-003	Phoenixwood	Page	12 / 15
Edition	J		Compiler	
Effective Date	2017/07/11		Reviewer	

**3 Panels: for LRR, L panel will be open first.**

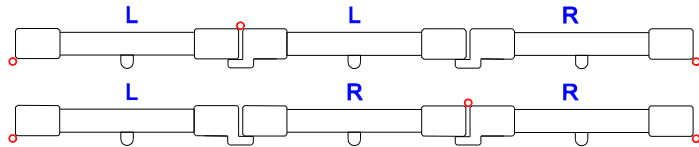

**4 Panels:**



6 panels or more: will be made like the following, astragal stile is only used where 2 panels meet without hinges.



**MUST FILL OUT THE PANEL CONFIGURATION ON THE ORDER FORM. SO THAT WE CAN KNOW WHERE THE HINGES ARE TO BE MOUNTED.**

## 7. Order Size:

**Overall Panel Size:** Size given is overall panel size, width is not includes the hinge space that from panel to batten on the left & right side, but includes the gap between panels. The height given must be net panel height. The hinges and magnets will be pre-installed to panel.

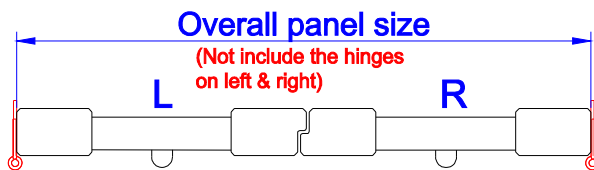

**OD of frame Size:** Size given is outside dimension of the shutter. No deduction will be taken. See the following drawings for details.

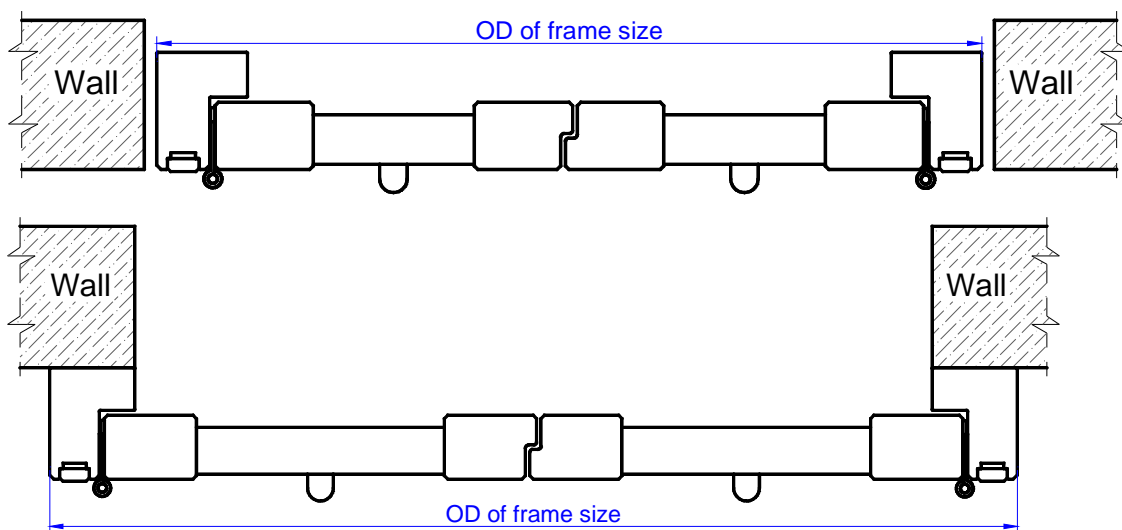

Blindtex Custom Shutter Specification				
Code	ERSH-003	Phoenixwood	Page	13 / 15
Edition	J		Compiler	
Effective Date	2017/07/11		Reviewer	

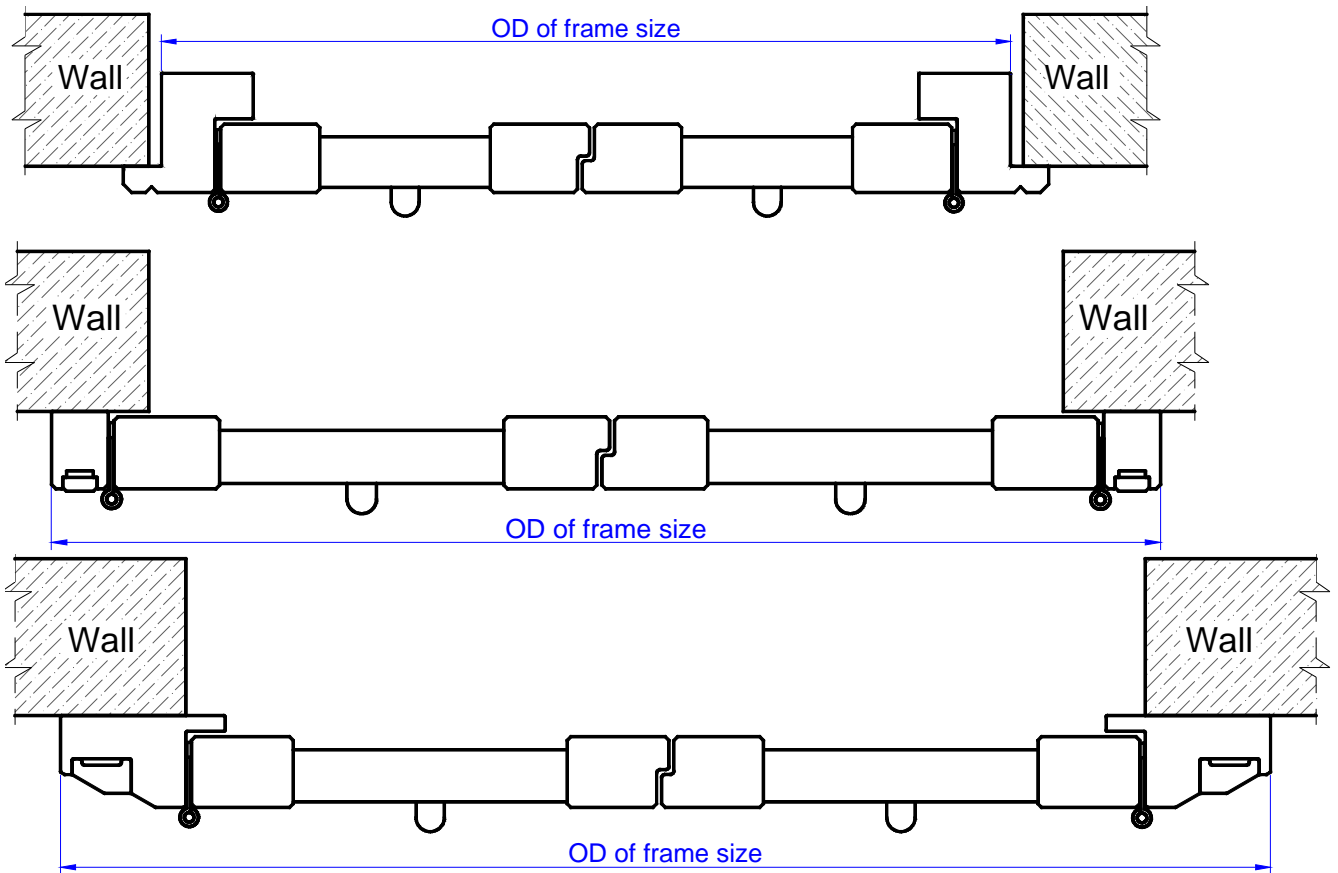

## 8. Solid panels:

### **Solid Raised**

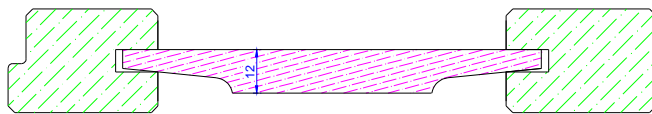

12mm Phoenix infill.

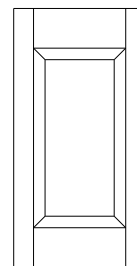

### **SS: Solid Shaker** Only available in Paint Color

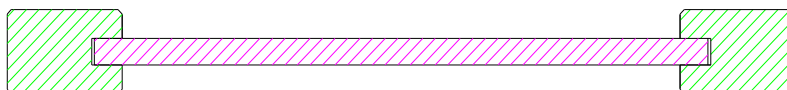

9mm MDF infill.

There is no warranty for the SS shutter in paint color.

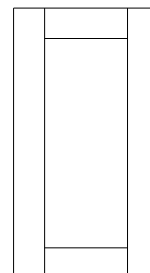

Blindtex Custom Shutter Specification				
Code	ERSH-003	Phoenixwood	Page	14 / 15
Edition	J		Compiler	
Effective Date	2017/07/11		Reviewer	

### **Solid Base**

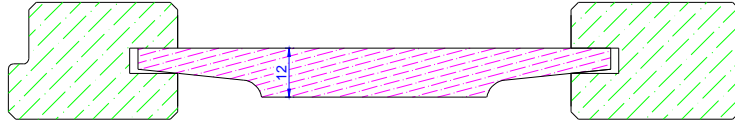

12mm Phoenix infill.



## 9. Mounting Type:

**Café Shutter:** Please specify on the order form if the shutter is a café style. We will finish the top of the panels and the end of battens.

**Tier on Tier:** Please specify the height of the bottom tier.

For multi-fold tier on tier shutter, only No. of Panel  $\leq 3$  is within warranty.

**Full height:** regular shutter in full height of window.

## 10. Tolerance:

**Width:** The width of the shutter can be plus or minus 1.6mm from the order width.

**Height:** The height of the shutter can be plus or minus 1.6mm from the order height.

**Divider rail location:** Divider rail location may be off by half a louvre space.

For 47mm louvre can be off by +/-19mm.

For 63mm louvre can be off by +/-25mm.

For 89mm louvre can be off by +/-38mm.

For 114mm louvre can be off by +/-51mm.

## 11. The standard gap at top and bottom of the panel and frame is 5mm when shutter is two sides.

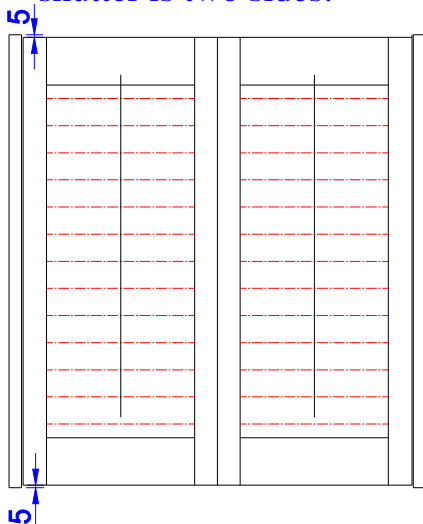

Blindtex Custom Shutter Specification				
Code	ERSH-003	Phoenixwood	Page	15 / 15
Edition	J		Compiler	
Effective Date	2017/07/11		Reviewer	

## 12. Cancellation:

Since NienMade China custom manufactures products based on the specifications you provided on the original order form, no cancellations will be accepted. Once the order is submitted, customer will be liable for the full amount of the shutter order.

## 13. Spare Louver:

**Spare louvers 2per pack:** For one item with uneven panel width, we will supply 2 louvers for each width.

## 14. Default Stile for LRR configuration:

It is default to open L panel first when the configuration is LRR.

## 15. Extended Frame

For orders in which the frames or hang strips (L/R) are ordered to an extended length warrantee will only apply where the shutter panels are supported in the closed position. Any RGA claim for such orders must show photographic evidence of the supported panels in the closed position.

## 16. Frames split

When frames length (including shutter frames, battens, fascia, header and track for track system) exceed the below limitation, then the frames will be split as the below chart described. Please review the chart below for reference.

Shipping Method	Frame length (L) (mm)
Standard shipping	3630<L ≤ 7260(2 sections) / L>7260(3 sections)
Airfreight	3048<L ≤ 6096(2 sections) / 6096<L ≤ 9144(3 sections)

## Notes:

☆ No warranty for horizontal T post length exceeds 1219mm.

## 17. Shutters to be installed in Angled or Horizontal Skylight Window Openings

If shutters are going to be installed in angled or horizontal skylight window openings, please specify on the order form.

Available Material	Wood Shutters (Not available for Motorized Shutters)
Available Frame Type	Frame with light block thickness not less than 3/4"(19.05mm)
Max Panel Size	26"(660mm) W x 78"(1981mm)H
Tilt Rod	Easy Tilt
Panel Configuration	single panel or single panels with T-Posts
Hardware for unhinged side	Barrel Bolt/Security Bolt/Roof Catch on top and bottom + 2 Button Catches

## 18. The Claim Limitation Date for Shipping Damage for Airfreight Orders:

For all airfreight orders with shipping damages, claims must be submitted within 1 week after the date of receipt.