

Blindtex Custom Shutter Specification				
Code	ERSH-007	White Teak	Page	1 / 13
Edition	H		Compiler	
Effective Date	2017/07/11		Reviewer	

# 1. Components:

## Frame options:

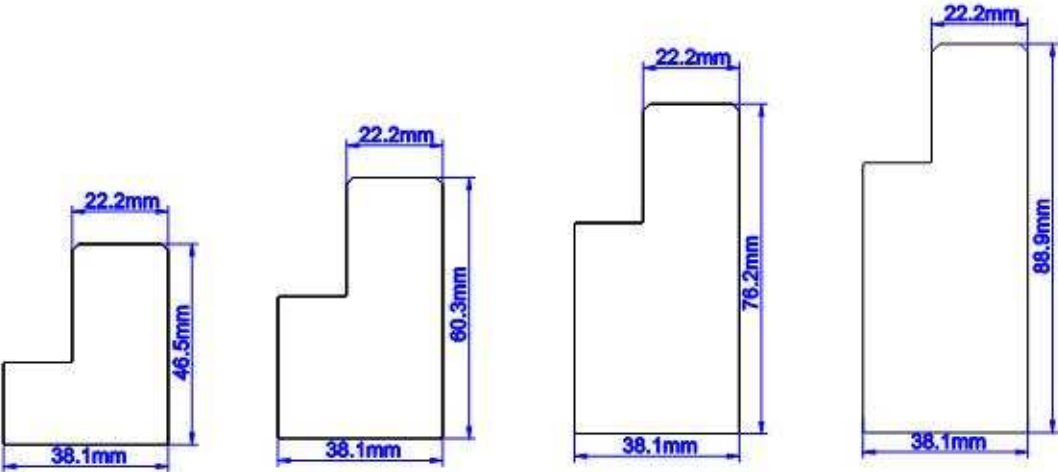

Chamfer L Frame 46mm      Chamfer L Frame 60mm      Chamfer L Frame 76mm      Chamfer L Frame 89mm

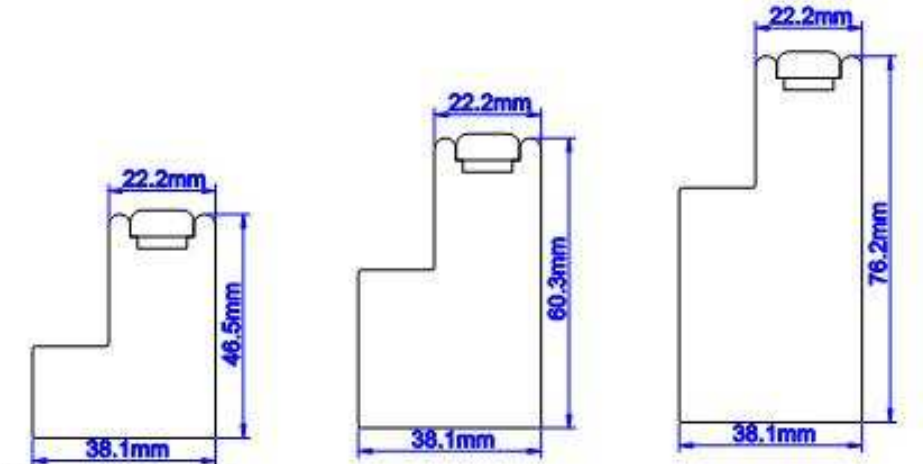

Vintage L Frame 46mm      Vintage L Frame 60mm      Vintage L Frame 76mm

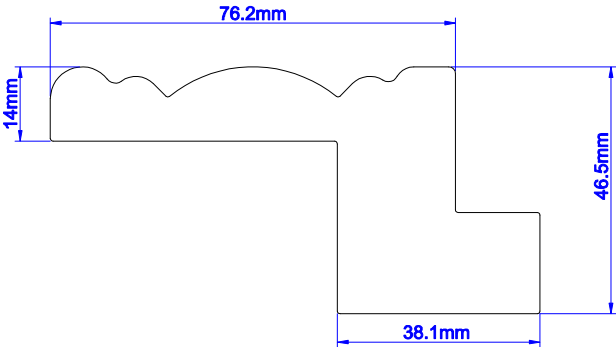

Crown Z Frame 76mm

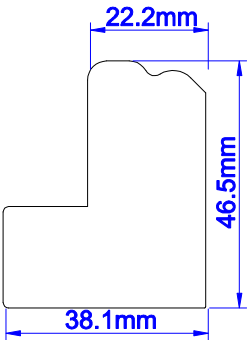

Crown Z Sill Plate

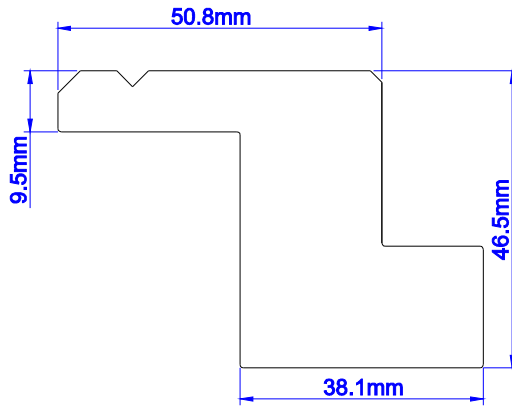

**Serrate Z Frame 50mm**

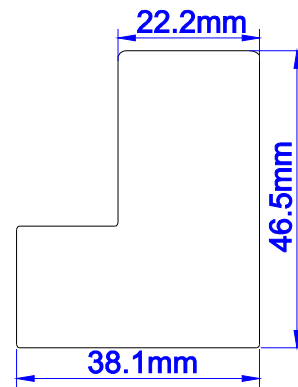

**Serrate Z Sill Plate**

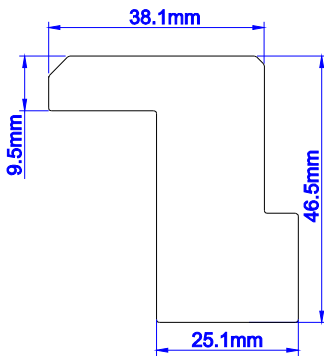

**Chamfer Z Frame 38mm**

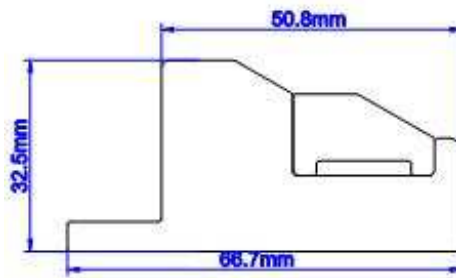

**Valley Deco Frame 50mm**

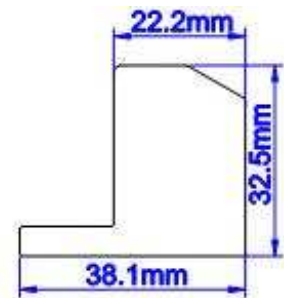

**Valley Deco Sill Plate**

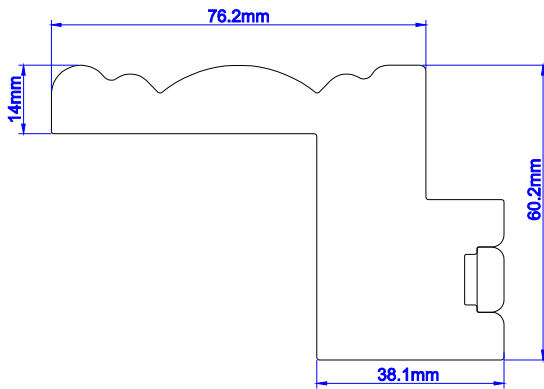

**Deep Crown Z Frame 76mm**

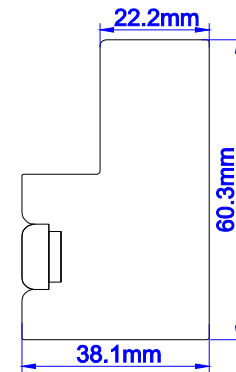

**Deep Plain L Frame 60mm**

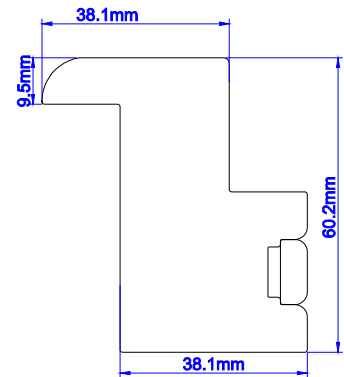

**Deep Bullnose Z Frame 38mm**

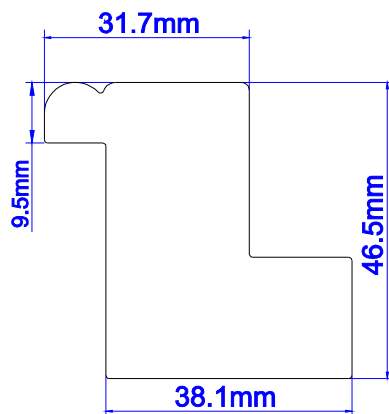

**Beaded Z Frame 31mm**

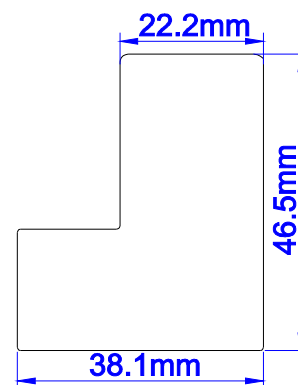

**Beaded Z Sill Plate**

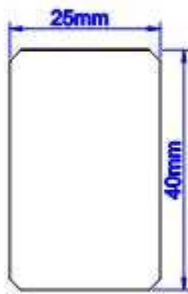

**Chamfer Hang Strip 40mm**

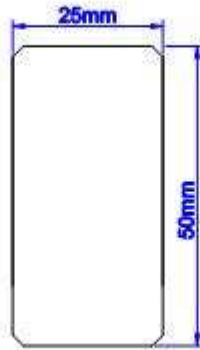

**Chamfer Hang Strip 50mm**

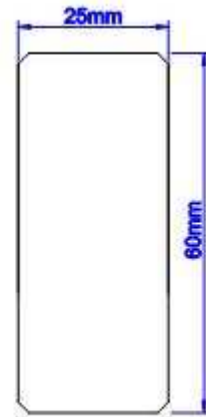

**Chamfer Hang Strip 60mm**

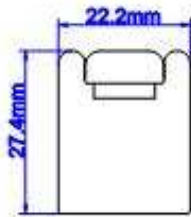

**Vintage Hang Strip 22mm**

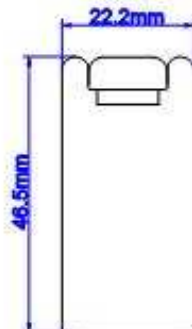

**Vintage Hang Strip 46mm**

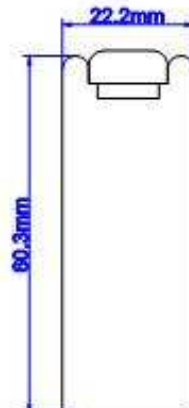

**Vintage Hang Strip 60mm**



**Vintage Hang Strip 76mm**

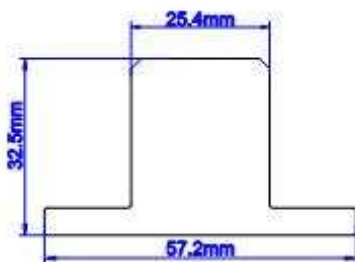

**Chamfer T Post (Deco)**

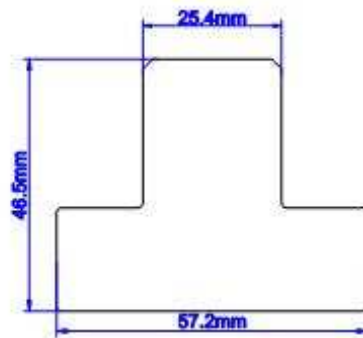

**Chamfer T Post (L/Z/HS)**

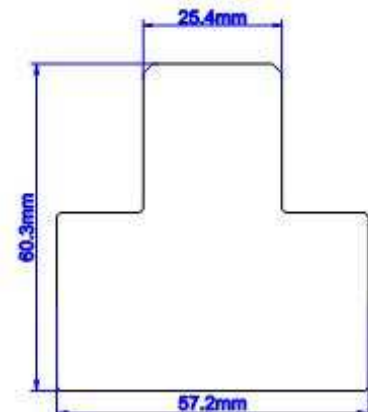

**Chamfer T Post 60mm**

## Optional T-post: Insert T-post

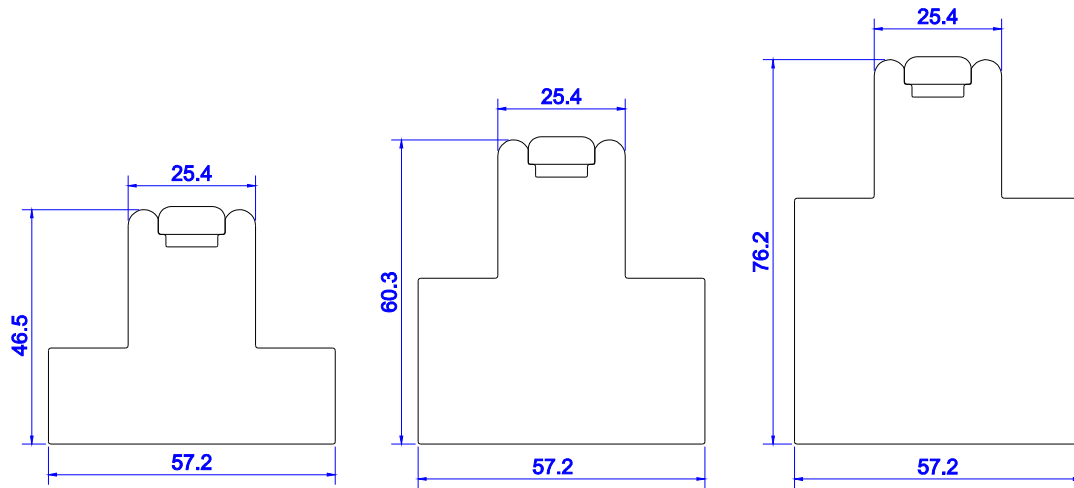

**T Post with insert 46mm**

**T Post with insert 60mm**

**T Post with insert 76mm**

## Stile:

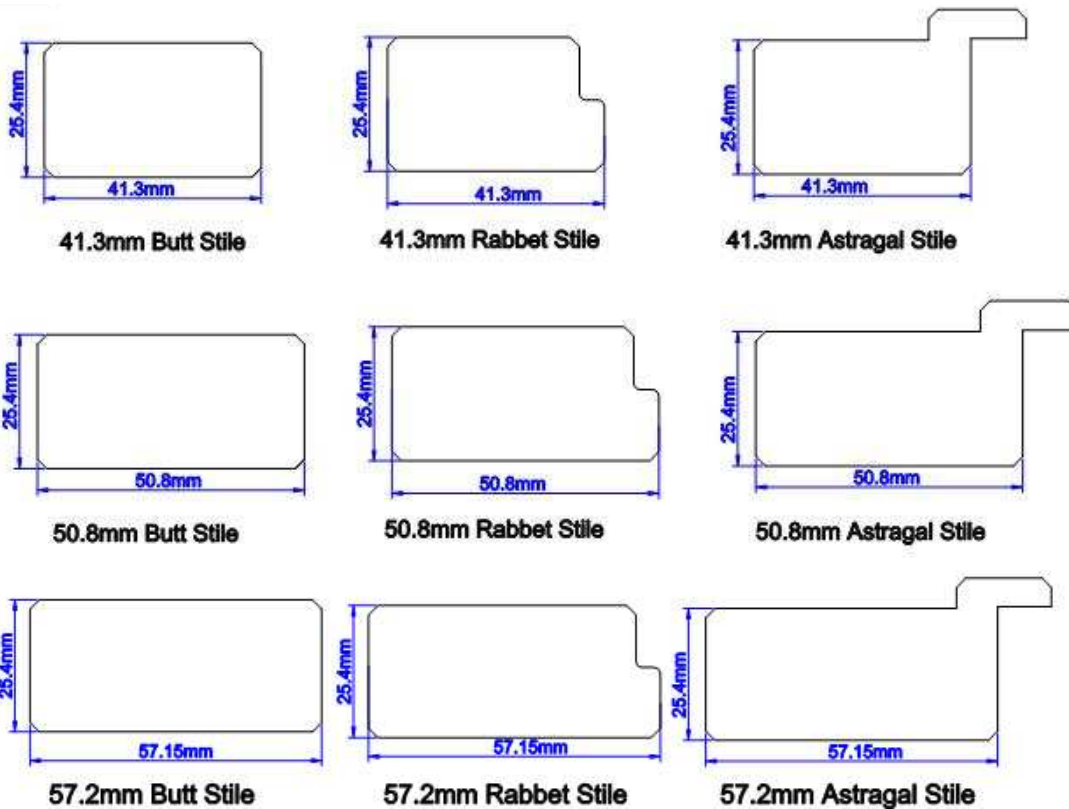

## Rails:

**Top & Bottom rail:** Usually the Top & Bottom rail will be larger than 80mm. Factory will decide the size, unless otherwise specified in the special instruction section on order form. The top and bottom rail will be approx. the same size if there is no divider rail. We suggest ordering shutters for the same customer at one time, so that the rail size will match.



**Divider rail:** Standard divider rail is 76.2mm.

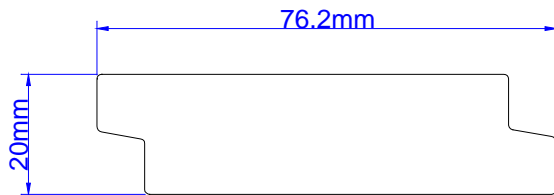

## **Battens:**

### **Standard sizes:**

Made of wood	
19mm x 19mm	25mm x 60mm
19mm x 25mm	25mm x 75mm
21mm x 21mm	27mm x 2.5mm
25mm x 30mm	62mm x 12mm
25mm x 40mm	63.5mm x 5mm
25mm x 50mm	

\* The Special shaped battens are available.

## **Louvres:**

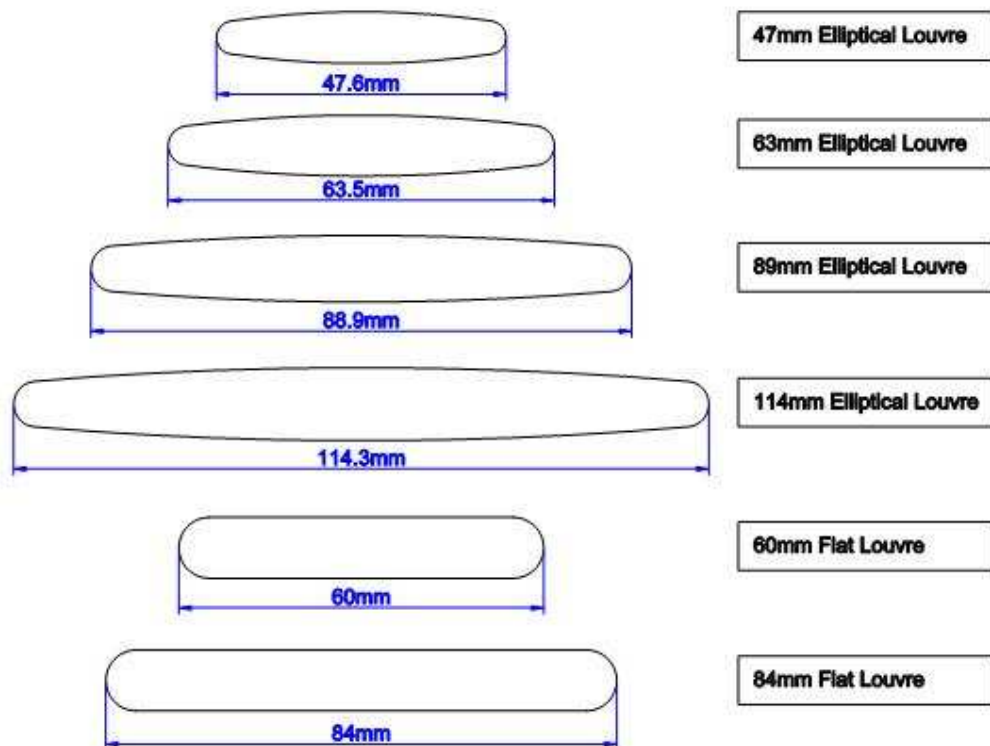

## **Tilt rod:**

1) Standard Tilt Rod:

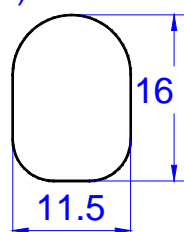

## 2) Offset Tilt Rod:

Tilt rod can be ordered offset from centre. Please specify the position from the centre of the tilt rod to the end of the louver. The standard distance for an offset tilt rod is 25mm to the end of the louver, measuring from hinge side.

3) **Easy Tilt system:** The stile that holding the pinion gear & rack will have a groove and cover strip. Number of louvers exceeds the following will have separate gear tilt control:

Louvre Size	Louvre Qty
63/60mm	24
89/84mm	16
114mm	12

If the louver qty exceeds the above limit, the gear tilt control will be equally split into halves. If the louver qty is odd, will make the bottom section one more louver than the top section. If the panel has a divider rail, and the louver qty above divider rail or below divider rail exceeds above limited, split tilt rods are also required.

### \*\*\*Offset tilt rod for multi-fold shutters:

For the multi-fold panels, we will make the tilt rod offset from the centre. By doing so, panels can be folded flat without tilt rods being obstructed with each other. The standard offset for the tilt rod is 7mm from the centre, i.e. tilt rod will be 7mm to the left from the centre for the left panels, and 7mm to the right from the centre for the right panels.

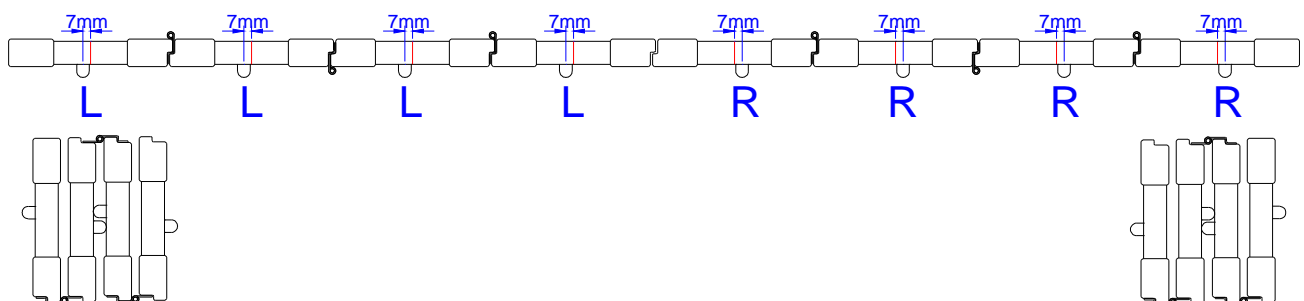

For 2 panels (LL/RR) and 4 panels (LLRR) configuration, there is no need to offset the tilt rod.

## 2. Panel configuration:

**Rabbit Stile:** if choose rabbit stile on the order form, then the panels will be made like the following drawings.

1 Panel: L or R



2 Panels: LL/RR/LR

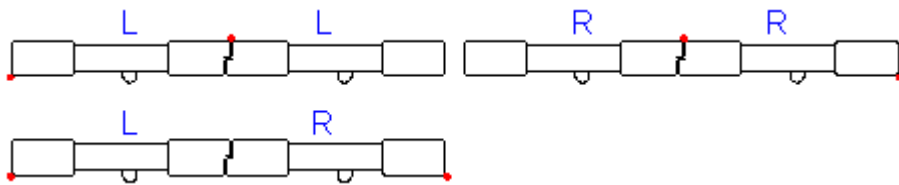

### 3 Panels: LLR/LRR

For LRR, L panel will be open first.

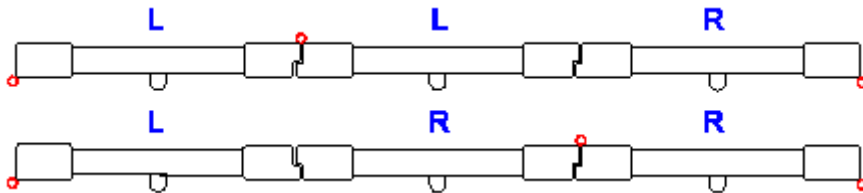

### 4 Panels: LLRR

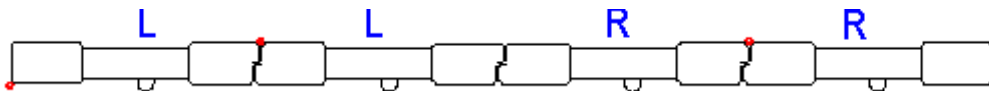

**Astragal Stile:** If choose astragal stile in the order form, then panels will be made like the following drawings.

### 1 Panel L or R: (both side to be butt stile)



### 2 Panels:

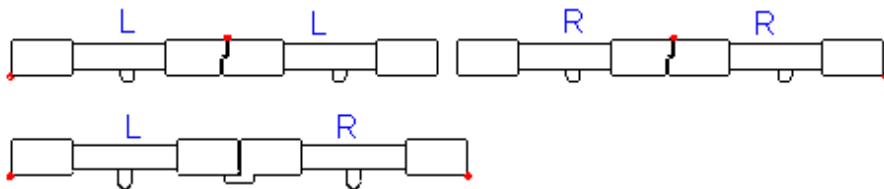

### 3 Panels: for LRR, L panel will be open first.

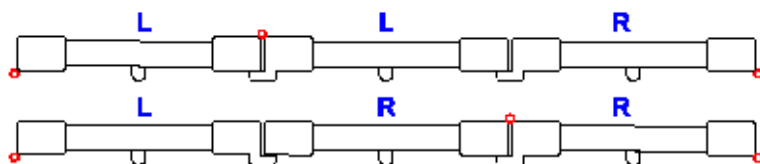

### 4 Panels:

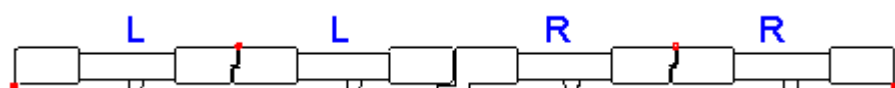

6 panels or more: will be made like the following, astragal stile is only used where 2 panels meet without hinges.

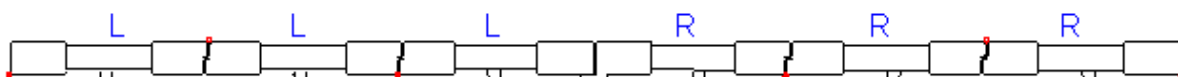

### 3. Colour Options and Coordinations

Total 50 colors: 21 paint colors and 29 stain colors.

Color ID	Color Name	Default Hinge Colour	Default Track Colour
001	Pure White	Pure White	White
003	Silk White	White	
004	Bright White		
006	Pearl	Pearl	
007	Ivory Lace		
008	Marshmallow		
009	Creamy	Bisque	
011	Cameo		
012	Crisp Linen		
013	Bisque		
016	Butter		
019	String		
030	Moondust	Nickel Plated	Anodised Silver
032	Sea Mist		
046	Ice	White	White
048	Chai	Nickel Plated	Anodised Silver
049	Stone Gray		
051	Brown Gray		
053	Clay		
063	Decorators White	White	White
836	Classic Black	Black	Anodised Silver
108	Rustic Gray	Nickel Plated	Anodised Silver
110	Limed White	White	White
114	Taupe	Nickel Plated	Anodised Silver
200	Natural	Antique Brass	Coffee
202	Golden Oak		
204	Oak Mantel		
205	Goldenrod		
206	Pecan		
211	Cherry		
212	Dark Teak		
214	Cocoa		
215	Cordovan		
219	Mahogany		
220	New Ebony		
221	Black Walnut		



227	Red Oak		
229	Rich Walnut		
230	Old Teak		
231	Spring Rose		
232	Red Mahogany		
233	Dark Mahogany		
237	Wenge		
242	Auburn		
247	Bark		
248	Pretzel		
249	Acorn		
250	Sumatra		
251	Raisin		
252	Toffee		

Due to the nature of material manufacturing, colours may vary slightly between dye lots. Please order shutters for the same home at one time. Slight variations may also occur between the finished products and the colour decks. For any additional orders, to ensure closer match to previous shutters, please send back a colour swatch.

The 836 classic black will have surcharge as custom color.  
Custom colour is also available with a surcharge.

## 4. General product specification

### *Panel size limitation:*

Louver size	Min.	Max.		
		Single Hung	Bi-fold hinged shutter/ Multi-fold with top&bottom track	Multi-fold hinged shutter/ Multi-fold with top track only
47mm	152mm	750mm	660mm	550mm (No. of panels ≤ 4)
63/60mm	152mm	890mm		
89/84mm	152mm	1047mm		
114mm	152mm	1047mm		

If panel size is out of spec, on hold query will be sent for confirm instead of waving warranty automatically.

A divider rail is required for every panel height over 1981mm. Within a panel, for every 1981mm, a divider rail is required. If specify no divider rail, we will regard it as you have waived your warranty.

\*For circle and oval shape, if the panel width exceeds the size limit above, making with center stile is not available and it is suggested to change the panel configuration to RTL. However, if panel width is within spec, it can be made with center stile.

### ***Shutter used for door without bottom support:***

In situations when shutters are used for door application, which do not have support underneath the panels, the customers must inform NienMade when placing the type of order.

(1) The factory will add extra hinges to support the panels.

(2) Wider Top and Bottom rail. This will reduce the probability of the panels sagging and increase panel integrity.

\* If customers fail to notify NienMade that the shutter will be used in door application and consequently, the customers will be responsible for the cost of any RGA Reorder that is submitted.

Panel Configuration L, R and LR are within warranty; but for LL/RR/LLRR, must order it with track or waive warranty.

## **5. Options**

### ***Mounting Type:***

**Café Shutter:** Please specify on the order form if the shutter is a café style. We will finish the top of the panels and the end of battens.

**Tier on Tier:** Please measured the split location from the bottom.

For multi-fold tier on tier shutter, only No. of Panel  $\leq 3$  is within warranty.

**Full height:** regular shutter in full height of window.

### ***Solid panels:***

#### **Solid Raised**

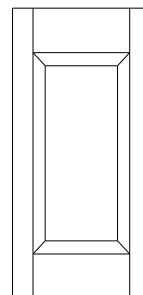
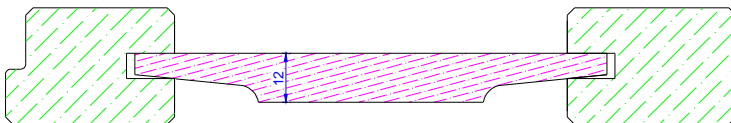

#### **Solid Base**

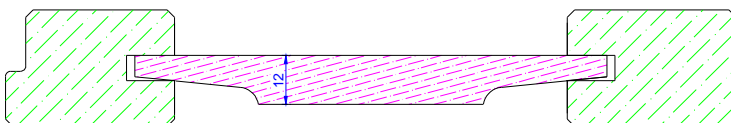

- ◆ The standard gap at top and bottom of the panel and frame is 5mm when shutter is two sides.

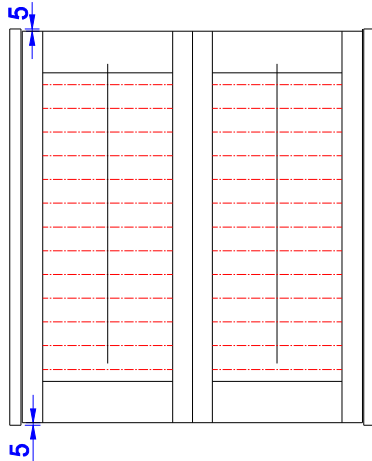

## 6. Order Size Definition

**Overall Panel Size:** Size given is overall panel size, width does not include the hinge space between panel and batten, but includes the gap between panels. The height given must be net panel height. The hinges and magnets will be pre-installed to panel.

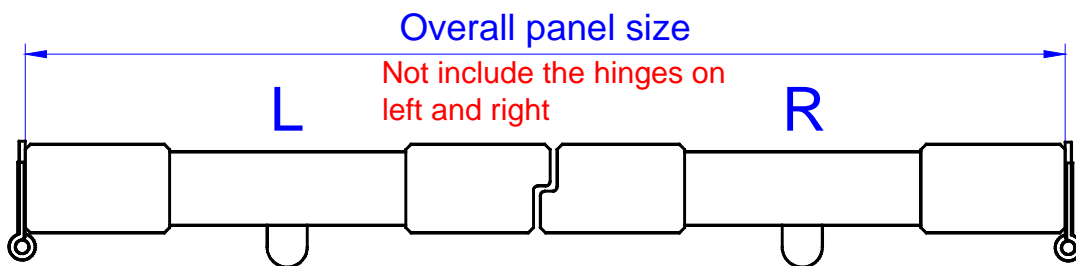

**OD of frame Size:** Size given is outside dimension of the shutter. No deduction will be taken. See the following drawings for details.

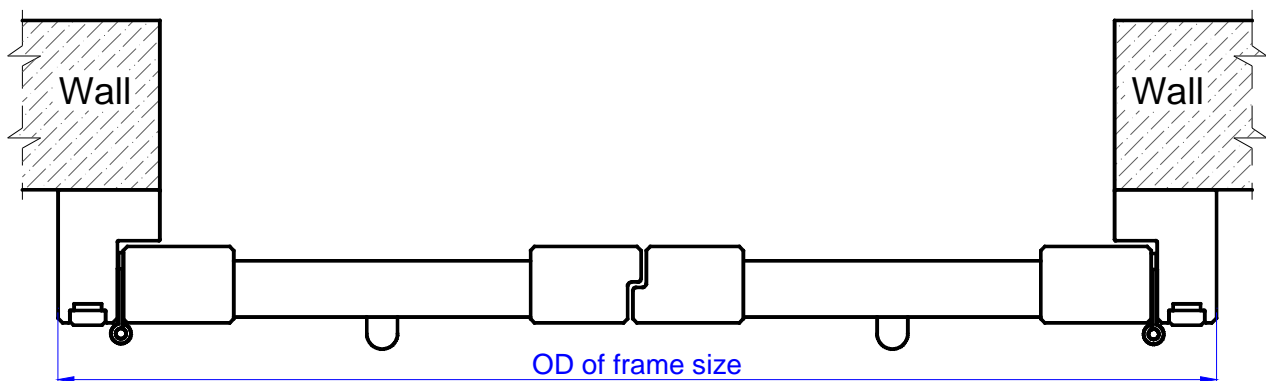
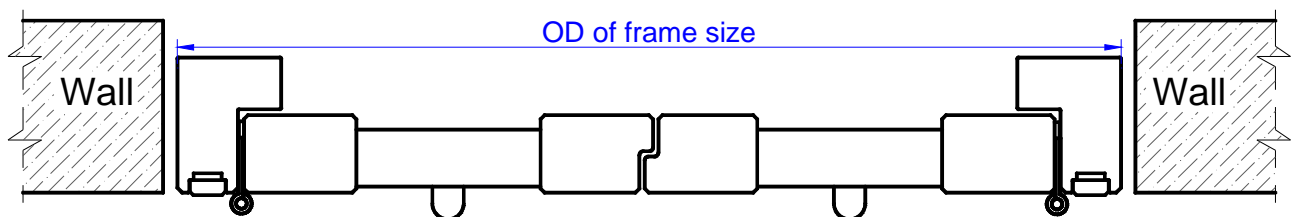

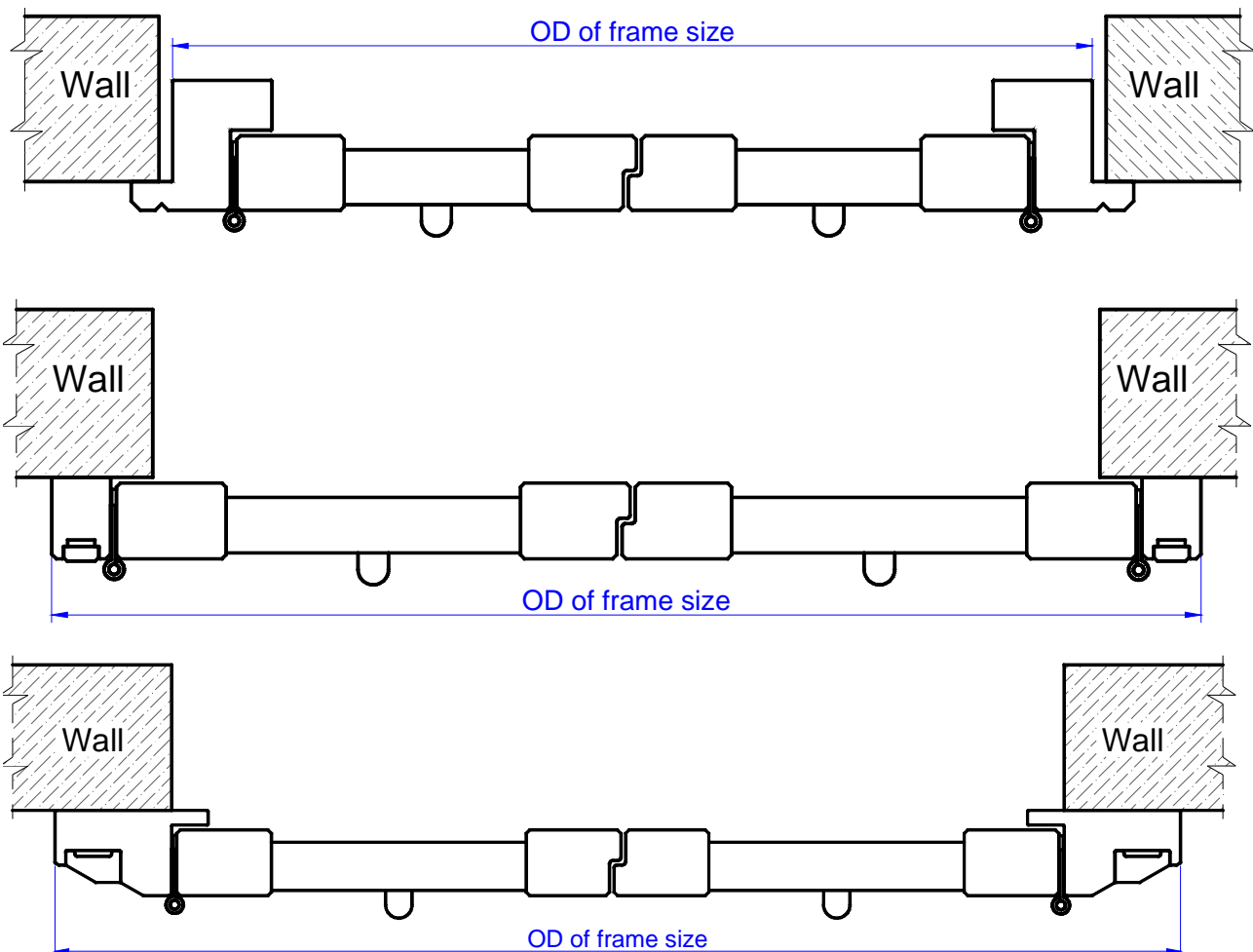

### ***Tolerance:***

**Width:** The width of the shutter can be plus or minus 1.6mm from the order width.

**Height:** The height of the shutter can be plus or minus 1.6mm from the order height.

**Divider rail location:** Divider rail location may be off by half a louvre space.

Louvre Size	Allowable Deviation
47mm	19mm
63/60mm	25mm
89/84mm	38mm
114mm	51mm

## **7. Policy**

### ***Cancellation:***

Once an order has been submitted and is not on hold, cancellations will not be accepted.

### ***Warranty:***

- \*The Color Fastness is warranted for 3 years.
- \*Workmanship is warranted for 3 years.
- \*Hardware is warranted for 1 year.
- \*Stainless Steel Hardware is warranted for 3 year.

## 8. Spare Louver:

Spare louvers 2per pack: For one item with uneven panel width, we will supply 2 louvers for each width.

## 9. Default Stile for LRR configuration:

It is default to open L panel first when the configuration is LRR.

## 10. Extended Frame

For orders in which the frames or hang strips (L/R) are ordered to an extended length warrantee will only apply where the shutter panels are supported in the closed position. Any RGA claim for such orders must show photographic evidence of the supported panels in the closed position

## 11. Frames split

When frames length (including shutter frames, battens, fascia, header and track for track system) exceed the below limitation, then the frames will be split as the below chart described. Please review the chart below for reference.

Shipping Method	Frame length (L) (mm)
Standard shipping	$3630 < L \leq 7260$ (2 sections) / $L > 7260$ (3 sections)
Airfreight	$3048 < L \leq 6096$ (2 sections) / $6096 < L \leq 9144$ (3 sections)

### Notes:

☆ No warranty for horizontal T post length exceeds 1219mm.

## 12. Shutters to be installed in Angled or Horizontal Skylight Window Openings

If shutters are going to be installed in angled or horizontal skylight window openings, please specify on the order form.

Available Material	Wood Shutters (Not available for Motorized Shutters)
Available Frame Type	Frame with light block thickness not less than 3/4"(19.05mm)
Max Panel Size	26"(660mm) W x 78"(1981mm)H
Tilt Rod	Easy Tilt
Panel Configuration	single panel or single panels with T-Posts
Hardware for unhinged side	Barrel Bolt/Security Bolt/Roof Catch on top and bottom + 2 Button Catches

## 13. The Claim Limitation Date for Shipping Damage for Airfreight Orders:

For all airfreight orders with shipping damages, claims must be submitted within 1 week after the date of receipt.