

Blindtex Shutter+Shade Specification				
Code	ERSS-002	25mm Corded (for Shutter+Shade)	Page	1/4
Edition	F		Complier	
Effective Date	2017/07/11		Reviewer	

## 1. Terminology

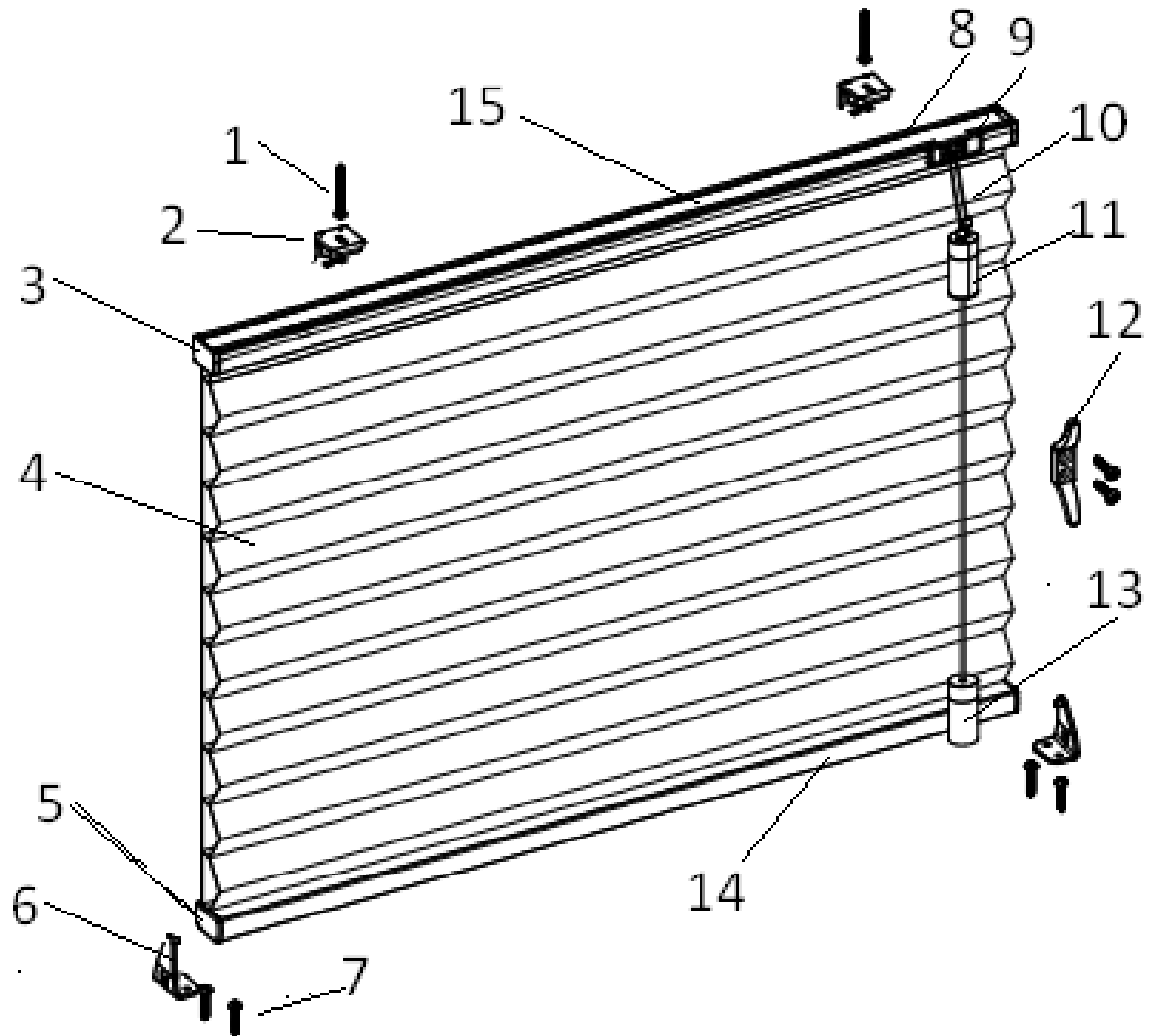

No	Description	No	Description
1	Screws for Installation Bracket	9	Cord Lock Assembly
2	Installation Bracket	10	Cord
3	Head Rail End Cap	11	Cord Consolidator
4	Blanket	12	Cord Cleat (Plastic)
5	Bottom Rail End Cap	13	Tassel
6	Hold Down Bracket	14	Bottom Rail
7	Screw for Hold Down Bracket	15	Head Rail PVC Cover
8	Head Rail		

2. Components

- Head Rail

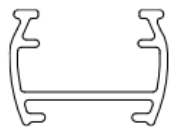

- Bottom Rail:

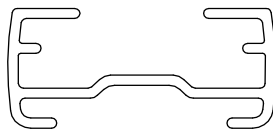

Blanket: 25mm single cell. The width is 25.4mm when stacked.

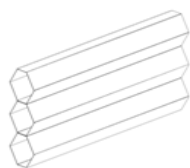

- Insta-lock

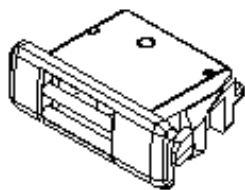

- Ellipse Safety Cord Connector & Ellipse Tassel Assembly

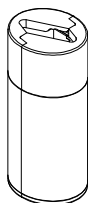

Ellipse Safety Cord  
Connector Assembly

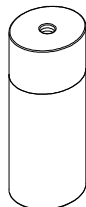

Ellipse Tassel Assembly

- Installation Brackets

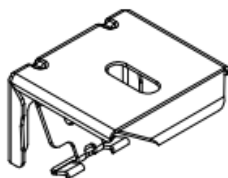

- Hold Down Bracket (Optional)

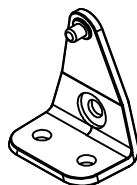

- Cord Cleat

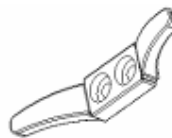

2pcs for each opening

Install on light block between panel and shade

### 3. General Specification

- Size Limitation

Item		Min Size	Max Size	Max. Area
Single Shade	Shade Width	8 1/2" (220mm)	96" (2,500mm)	60Sqft (5.5 SQM)
	Shade Height	10" (250mm)	144" (3,600mm)	

- \* The above chart does not mean that a shade can be ordered in maximum width and maximum height.
- \* The shade width & drop must be within the size limitation listed above.

- Control Position (for single shade)

Cord Lock Assembly	Default	Optional
	Right	Left

### 4. Colour Options: Room Darkening Colours

Colour coordination chart: Appendix 4

No.	Fabric	Fabric Color Code	Fabric Color Name
1	Room Darkening	C4001	Snow White
2	Room Darkening	C4510	Brie
3	Room Darkening	C4105	Dusk
4	Room Darkening	C4103	Mineral
5	Room Darkening	C4201	Black Ink
6	Room Darkening	C4101	Steel Gray
7	Room Darkening	C4102	Terra
8	Room Darkening	C4405	Teak
9	Room Darkening	C4504	Desert
10	Room Darkening	C4401	Warm Sand
11	Room Darkening	C4408	Chai
12	Room Darkening	C4511	Latte
13	Room Darkening	C4002	Whisper White
14	Room Darkening	C4402	Mocha
15	Room Darkening	C4601	Fog Green
16	Room Darkening	C4003	Glacier White

### 5. Order Size Definition

- Inside Mount:  
Shade Width = Order Width - 3/8" (9.5mm)  
Shade Height = Order Height
- Shade Width: measure from left of blanket to right of blanket
- Shade Height: measure from the top of head rail to the bottom of bottom rail when the shade is fully extended.
- Tolerance: Shade width may vary -1/8" (3mm) ~1/8" (3mm) and height may vary +1/4" (6mm) ~ + 3/4" (19mm)

## 6. Warranty

Colour Fastness: 1 year.

Structure: 1 year.

## 7. The Claim Limitation Date for Shipping Damage for Airfreight Orders:

For all airfreight orders with shipping damages, claims must be submitted within 1 week after the date of receipt.