

Blindtex Custom Shutter Specification				
Code	EM-021	2014 Bypass	Page	1 / 15
Edition	H		Compiler	
Effective Date	2016/07/01		Reviewer	

# Track Shutters—Bypass

## Guidelines and Specs:

**Material:** available for all shutter materials.

**Stile:** 41.3mm, 50.8mm, 57.1mm rabbet stiles are available,  
Center stile is not available.

**Panel size limitation:** same as the normal shutter spec.

### Size Definition:

#### Outside Mount

Max frame-to-frame width: window width + 76mm

Max frame-to-frame height: window height + 114mm

#### Semi-Inside Mount

Max frame-to-frame width: window width – 3.2mm

Max frame-to-frame height: window height + 35mm

#### Inside Mount

Max frame-to-frame width: window width -3.2mm

Max frame-to-frame height: window height – 3.2mm

Blindtex Custom Shutter Specification				
Code	<b>EM-021</b>	<b>2014 Bypass</b>	Page	<b>2 / 15</b>
Edition	<b>H</b>		Compiler	
Effective Date	<b>2016/07/01</b>		Reviewer	

Top View  
Outside Mount

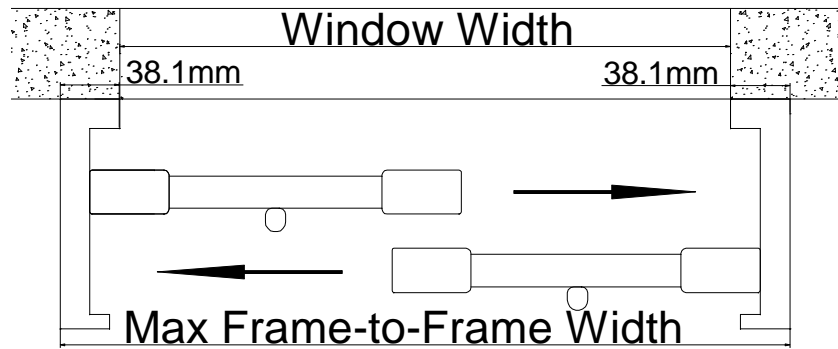

Semi-Inside Mount  
Window Width

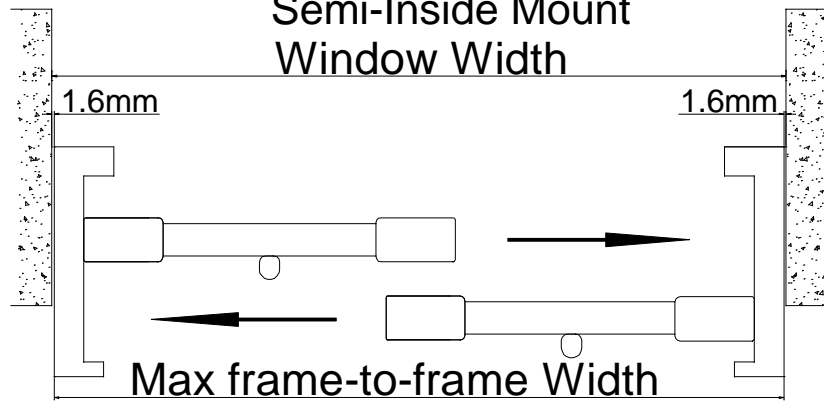

Inside Mount  
Window Width

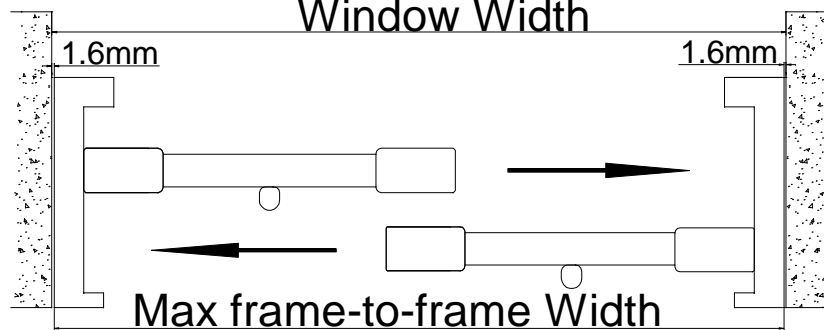

Blindtex Custom Shutter Specification				
Code	EM-021	2014 Bypass	Page	3 / 15
Edition	H		Compiler	
Effective Date	2016/07/01		Reviewer	

Top View

For shutters with 4 or more panels, please select “side open” or “center open” or “side Open”

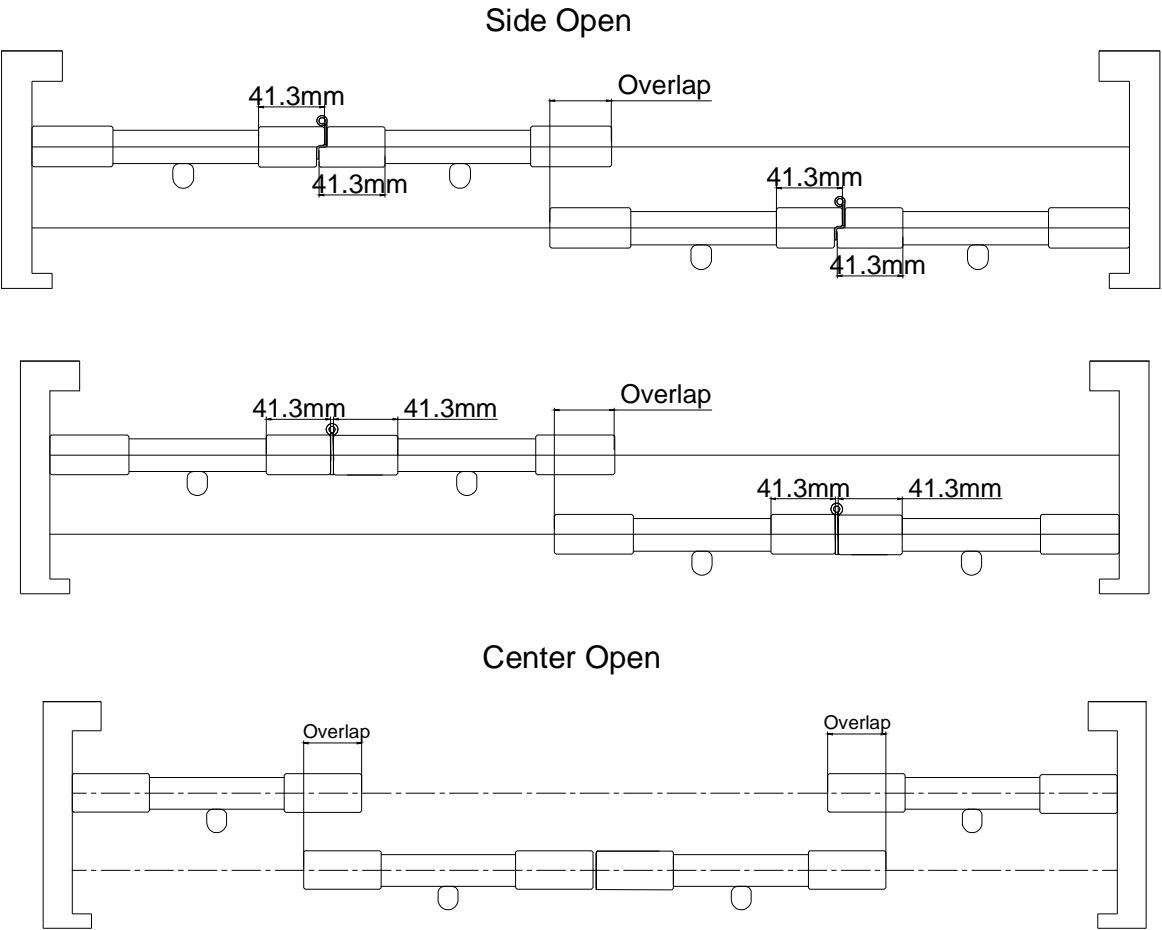

Blindtex Custom Shutter Specification				
Code	<b>EM-021</b>	<b>2014 Bypass</b>	Page	<b>4 / 15</b>
Edition	<b>H</b>		Compiler	
Effective Date	<b>2016/07/01</b>		Reviewer	

#### 4 panels side open w/Rabbet stile

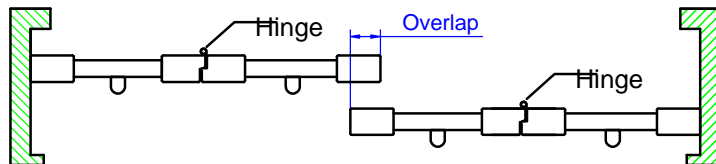

#### 4 panels center open w/Rabbet stile

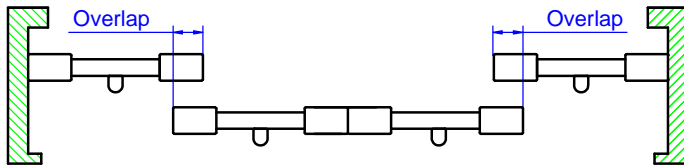

#### 6 panels side open w/Rabbet stile

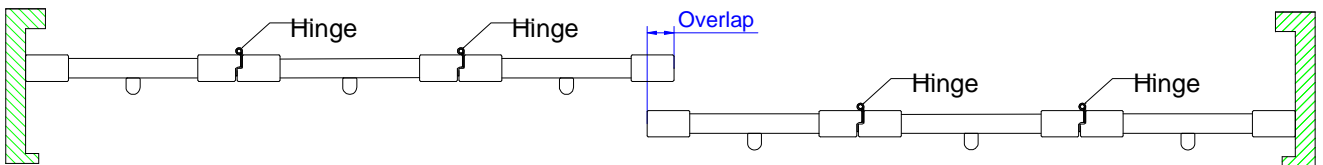

#### 6 panels center open w/Rabbet stile

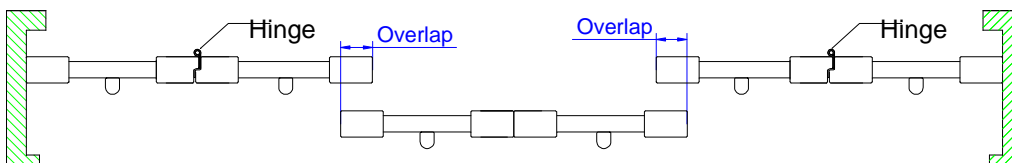

#### Notes:

The stile between hinged panels is 41.3mm stile.

The stile between hinged panels is butt stile or rabbet stile as per ordered, and default butt stile between non-hinged panels.

Blindtex Custom Shutter Specification				
Code	EM-021	2014 Bypass	Page	5 / 15
Edition	H		Compiler	
Effective Date	2016/07/01		Reviewer	

Size Definition

For Semi-Inside/OM without side boards

For IM without side boards

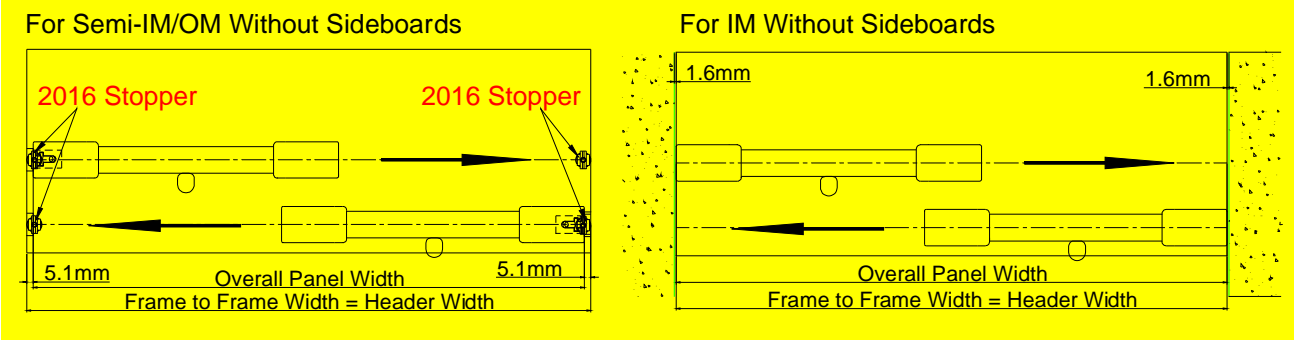

Note: For Semi-Inside/OM bypass without side boards but with fascia returns, 2016 Stopper will be supplied

Mounting Options (Closed Bypass)

Side View

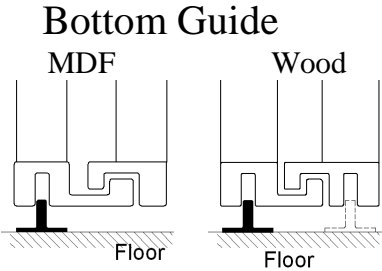
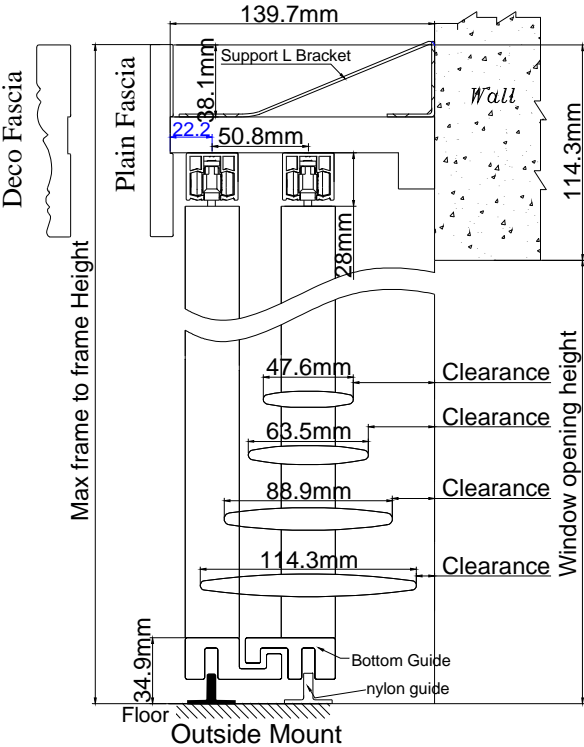

# Blindtex Custom Shutter Specification

Code	EM-021	2014 Bypass	Page	6 / 15
Edition	H		Compiler	
Effective Date	2016/07/01		Reviewer	

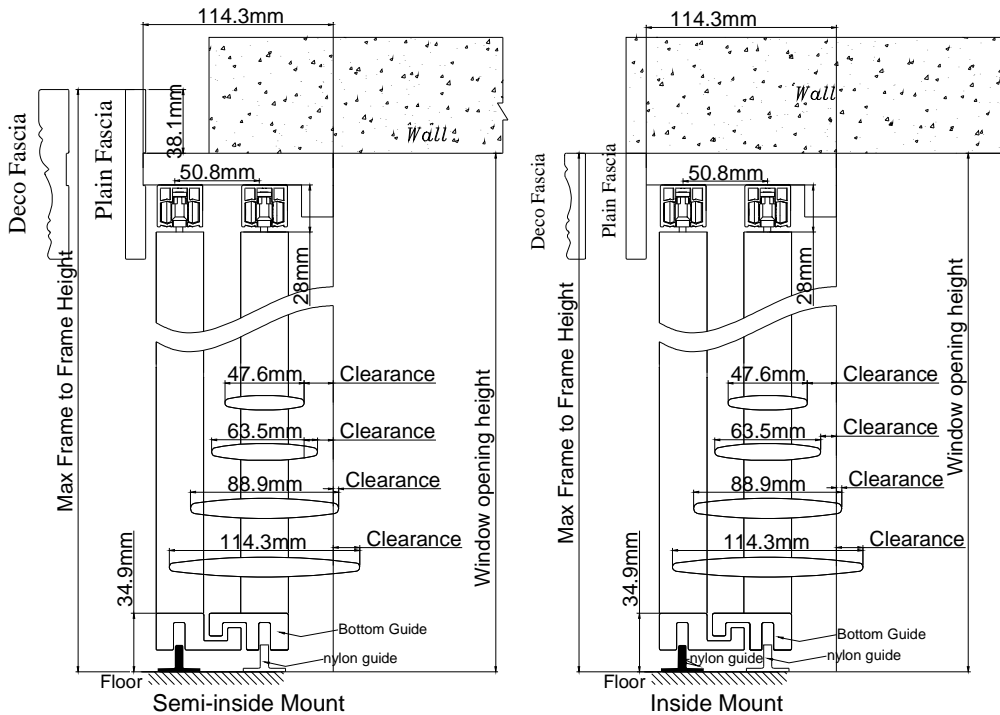

## Mounting Options (Closed Bypass with 3 Tracks): WOOD only

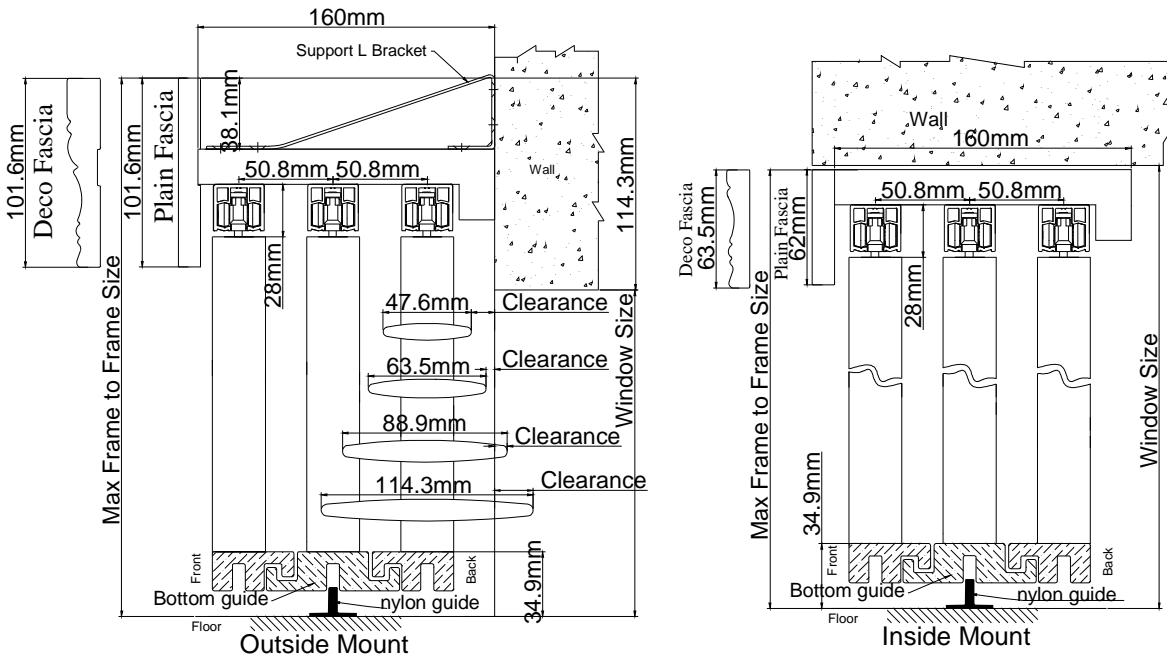

# Blindtex Custom Shutter Specification

Code	EM-021	2014 Bypass	Page	7 / 15
Edition	H		Compiler	
Effective Date	2016/07/01		Reviewer	

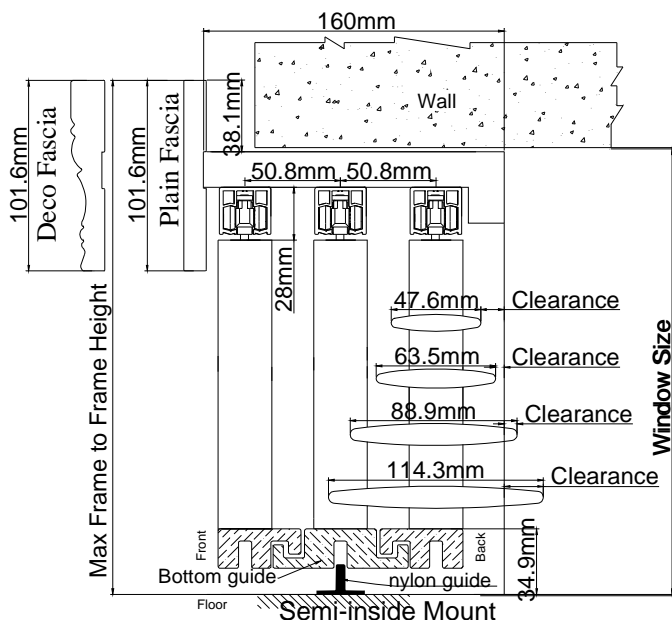

**Mounting Options (Opened Bypass):** Only available in 60mm, 63mm, 84mm and 89mm louvers.

## 60/63mm Louver

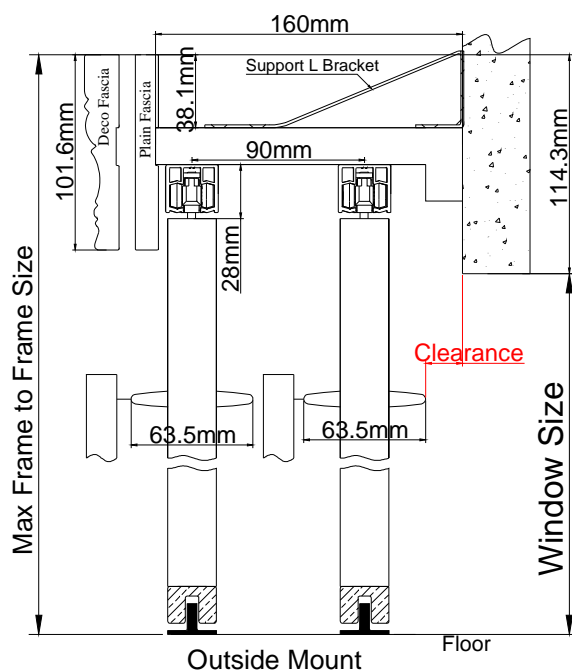

Blindtex Custom Shutter Specification				
Code	<b>EM-021</b>	2014 Bypass	Page	<b>8 / 15</b>
Edition	<b>H</b>		Compiler	
Effective Date	<b>2016/07/01</b>		Reviewer	

Code	<b>EM-021</b>	2014 Bypass	Page	<b>8 / 15</b>
Edition	<b>H</b>		Compiler	
Effective Date	<b>2016/07/01</b>		Reviewer	

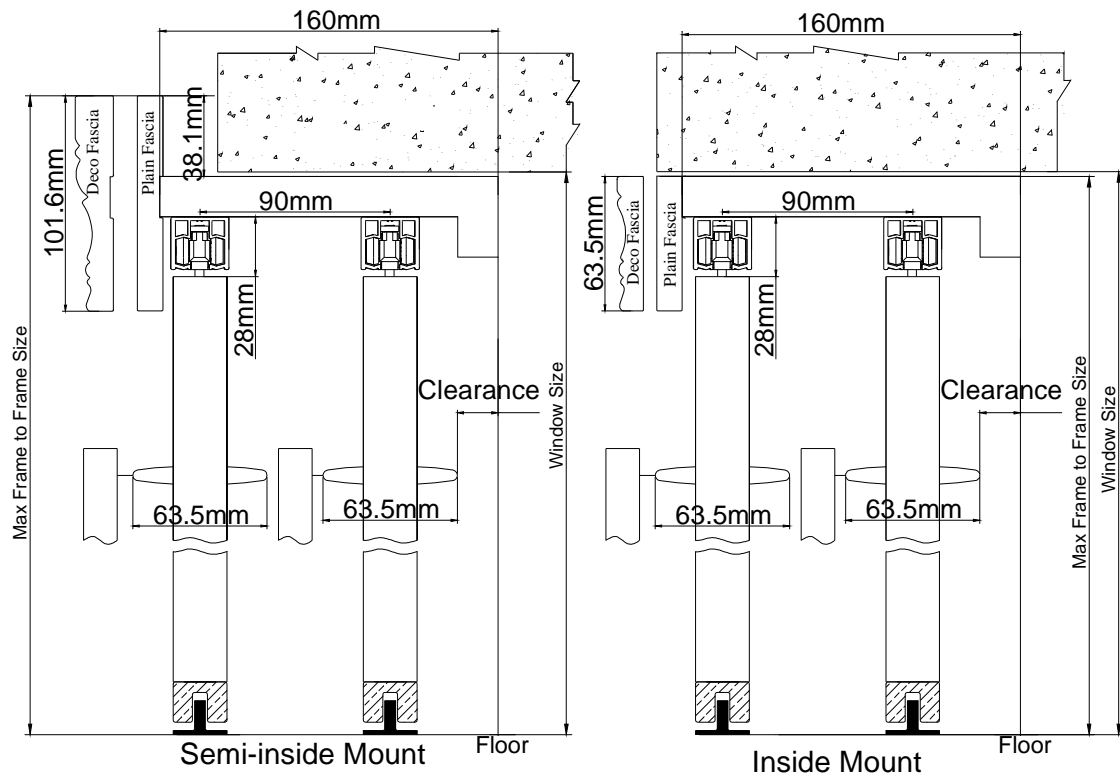

### Mounting Options (Opened Bypass) 84/89mm Louver

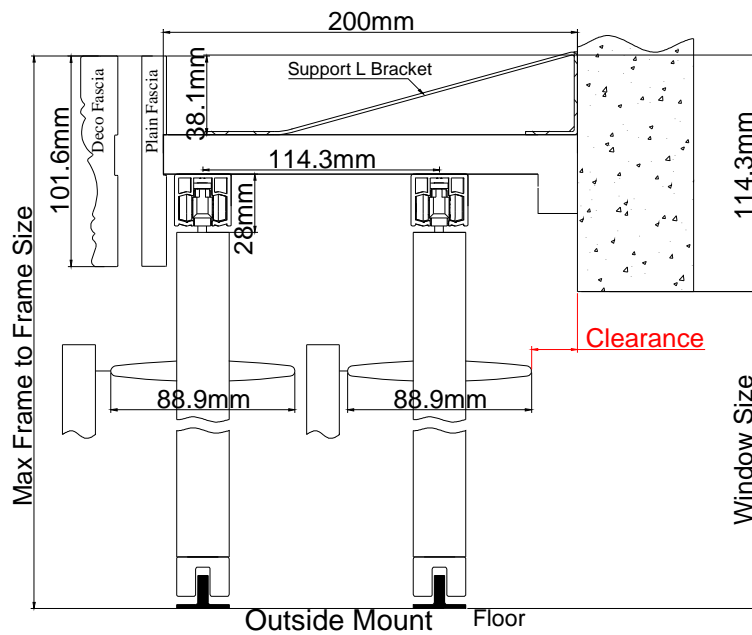



Blindtex Custom Shutter Specification				
Code	EM-021	2014 Bypass	Page	9 / 15
Edition	H		Compiler	
Effective Date	2016/07/01		Reviewer	

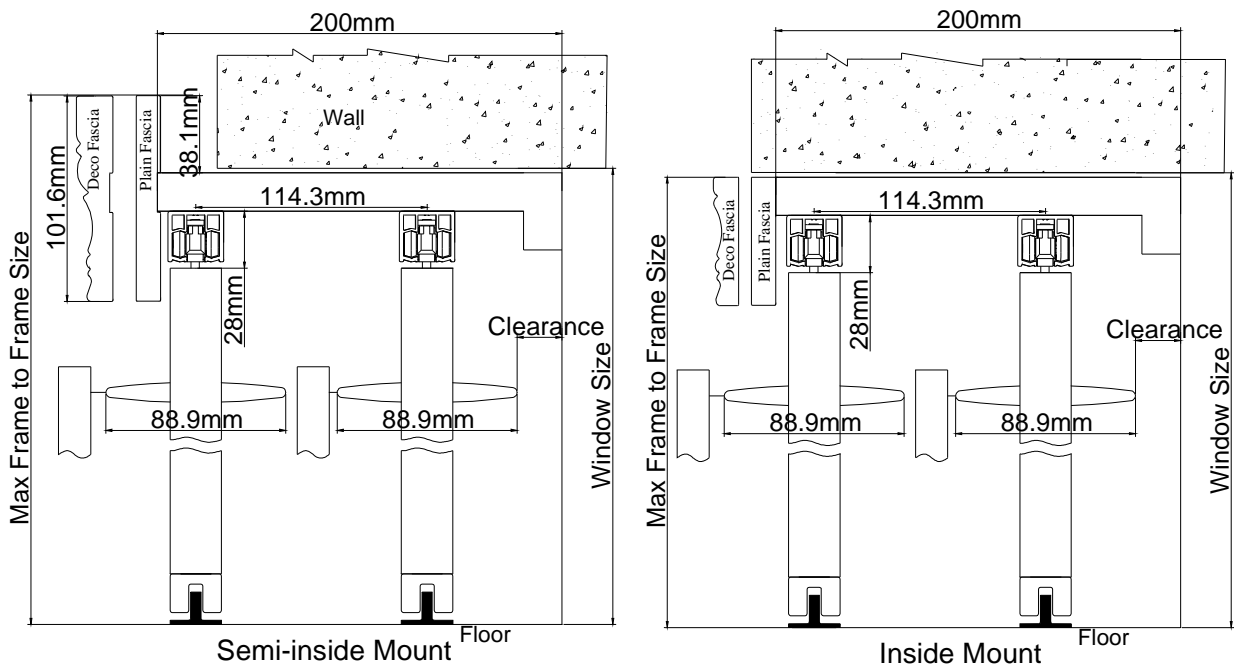

**Bottom Guide for Open By Pass:**

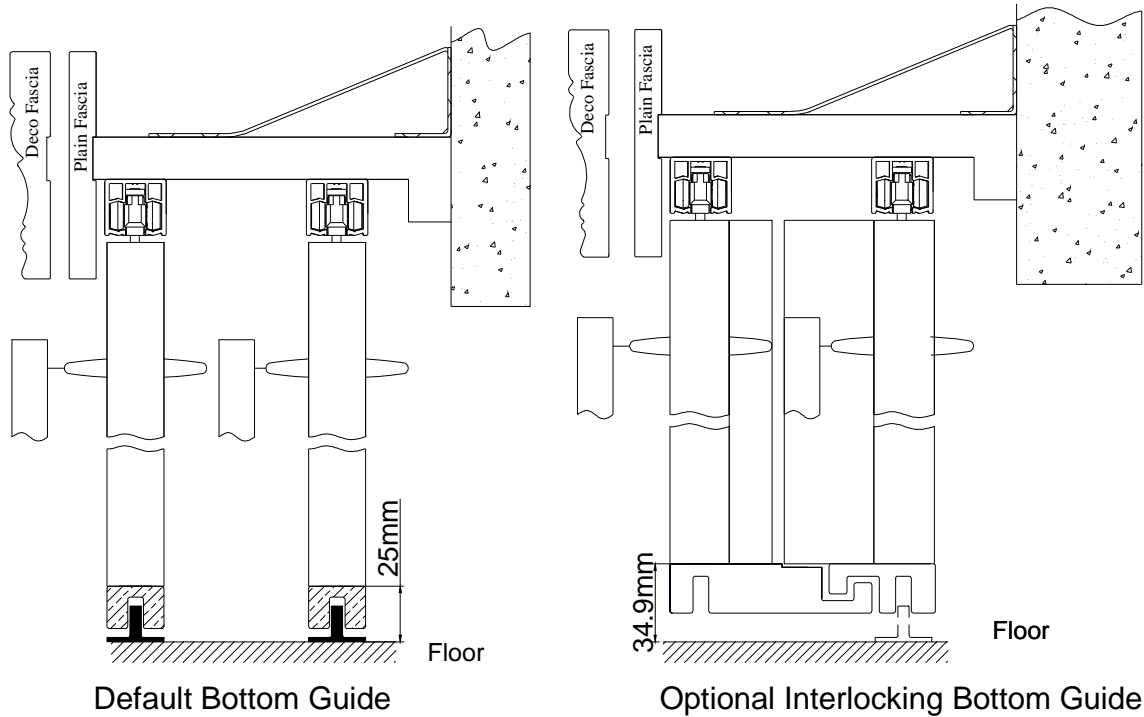

Blindtex Custom Shutter Specification				
Code	EM-021	2014 Bypass	Page	10 / 15
Edition	H		Compiler	
Effective Date	2016/07/01		Reviewer	

Opened Bypass

Top View

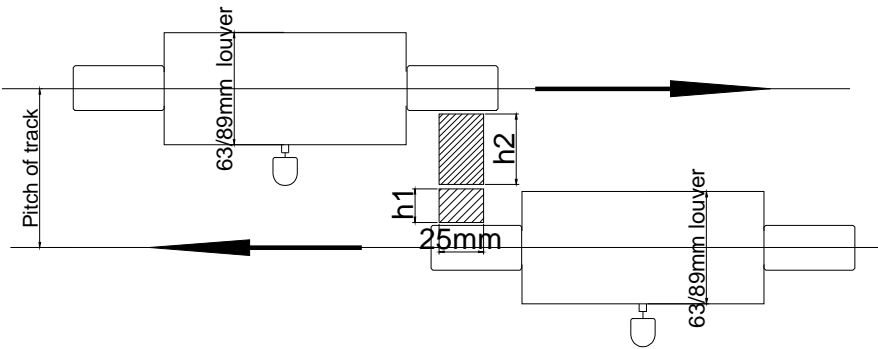

Bypass with U Bottom Track:

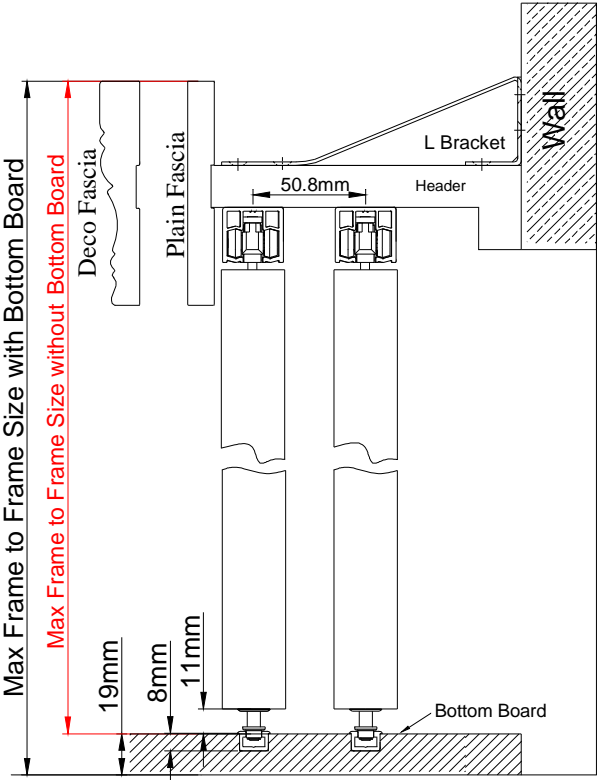

Bypass with M Bottom Track:

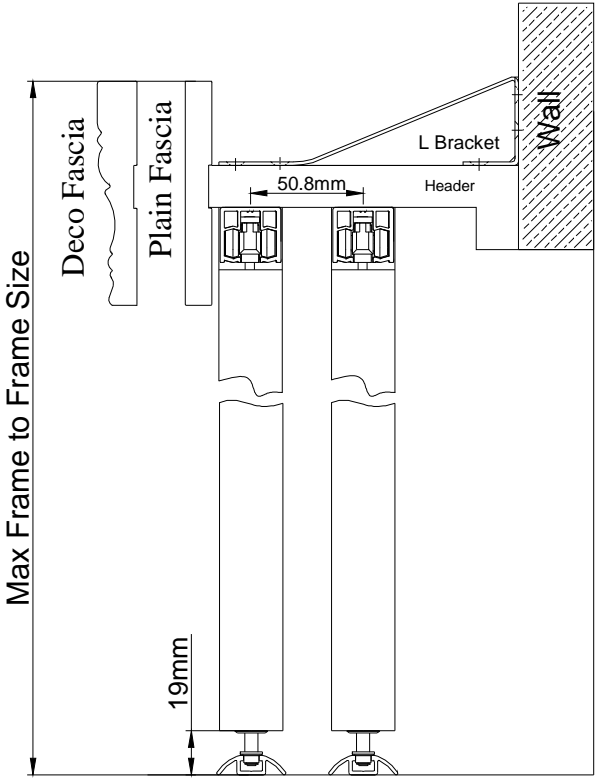

Blindtex Custom Shutter Specification				
Code	EM-021	2014 Bypass	Page	11 / 15
Edition	H		Compiler	
Effective Date	2016/07/01		Reviewer	

#### Clearance:

Closed Bypass	Top Frame Size (mm)	Louver Size(mm)	Clearance(mm)
	139.7	47.6	42.9
		63.5	34.9
		88.9	22.2
		114.3	9.5
	114.3	47.6	17.5
		63.5	9.5
		88.9	-3.2
		114.3	-15.9
Closed Bypass with 3 Tracks	Top Frame Size (mm)	Louver Size(mm)	Clearance(mm)
	160	47.6	12.4
		63.5	4.4
		88.9	-8.3
		114.3	-21.0
Open Bypass	Top Frame Size(mm)	Louver Size(mm)	Clearance(mm)
	160	63.5	16.0
	200	88.9	19.0

#### Pitch of track:

Louver	U shape bottom guide		Interlocking bottom guide	
	Standard Tilt Rod	Easy Tilt	Standard Tilt Rod	Easy Tilt
60/63mm	90mm	70mm	90mm	90mm
84/89mm	114mm	92mm	114mm	114mm

#### Light block thickness of panels:

Louver		U shape bottom guide		Interlocking bottom guide		
		Standard Tilt Rod	Easy Tilt	Standard Tilt Rod	Easy Tilt	
		WOOD&MDF&ABS	WOOD&MDF&ABS	WOOD&MDF&ABS	Wood	MDF&ABS
60/63mm	h1	19mm	19mm	19mm	19mm	40mm
	h2	40mm	19mm	40mm	40mm	19mm
84/89mm	h1	30mm	30mm	30mm	30mm	50mm
	h2	50mm	30mm	50mm	50mm	30mm

Blindtex Custom Shutter Specification				
Code	EM-021	2014 Bypass	Page	12 / 15
Edition	H		Compiler	
Effective Date	2016/07/01		Reviewer	

### Track Dimension:

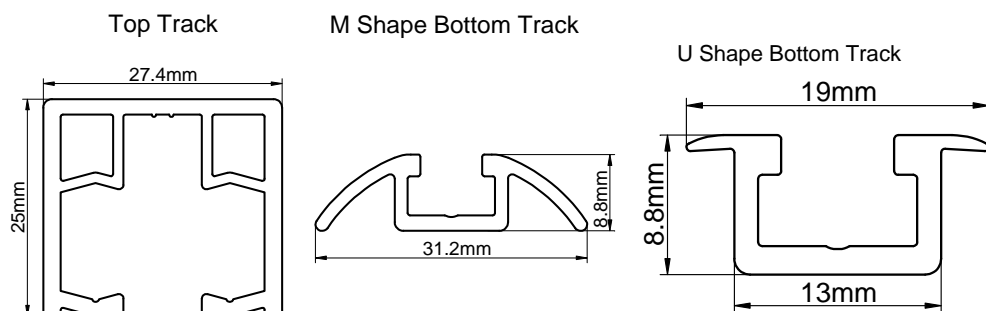

Note: If apply to U shape bottom track, the bottom board should be needed otherwise the customer need slot the floor to install the bottom track. Bottom Board width will be default same as the width of the U shape side frame.

**End Caps will be supplied for M shape bottom track for outside / semi-inside mount without side boards:**

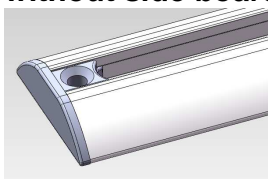

**Deduction for U Shape Bottom Track:** only available for full recess.

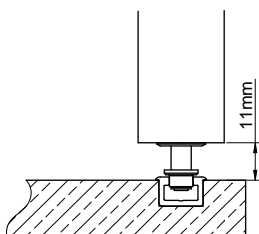

**Nylon Guide(Running Change):** The nylon guide is composed by 2 parts and will supplied as a whole set by default (bottom part 16mm and top part 5mm), please remove the top part if necessary.

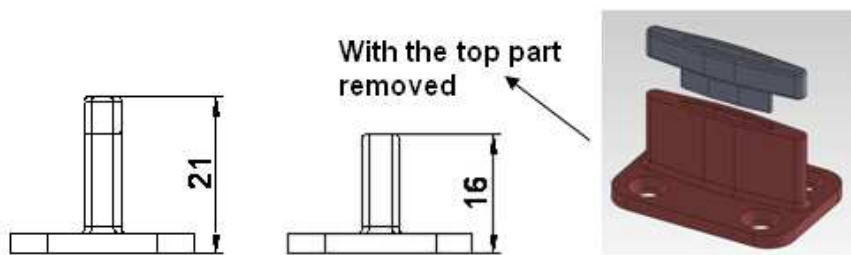

Blindtex Custom Shutter Specification				
Code	EM-021	2014 Bypass	Page	13 / 15
Edition	H		Compiler	
Effective Date	2016/07/01		Reviewer	

**Track Shutters Framing Materials (For waterproof ABS, only plain fascia is available)**

Framing	Size				Pc(s)
L Shape Header	Header (Closed Bypass)	Header (Opened Bypass)	Supporting Strip		1 pc
(2 in 1)	19mm x 140mm (Default for Outside Mount; Optional for Semi-Inside and Inside Mount)	19mm x 160mm ( 63mm Louver)	19mm x 19mm		
Header with Supporting Strip	19mm x 114mm (Default for Semi-Inside and Inside Mount; Optional for Outside Mount)	19mmx 200mm (89mm Louver)			
	Custom * ≤ 200mm	Custom * ≤ 200mm			
U Shape Side Frame	Side Frame (Closed Bypass)	Side Frame (Opened Bypass)	Supporting Strip	Side Fascia	2 pcs
(3 in 1)	19mm x 150mm (Default for Outside Mount; Optional for Semi-Inside and Inside Mount)	19mm x 169mm ( 63mm Louver)	19mmx 19mm	9.6mm x 32mm	
Side Frame with Supporting Strip & Side Fascia	19mm x 124mm (Default for Semi-Inside and Inside Mount; Optional for Outside Mount)	19mm x 210mm (89mm Louver)			
	Custom * ≤ 200mm	Custom * ≤ 200mm			
Top Fascia (Plain/Deco)	101.6mm (Semi-inside and Outside Mount)				1 pc
	12.7mm x 63mm (Inside Mount) 12mm x 62mm(Plain) (Inside Mount)				
Top Fascia Return	101.6mm(Semi-inside and Outside Mount)				2 pcs
	N/A (Inside Mount)				

Note: For U shape bottom track with bottom board, the bottom board depth is 19mm and width will match with the width of U shape side frame.

Blindtex Custom Shutter Specification				
Code	EM-021	2014 Bypass	Page	14 / 15
Edition	H		Compiler	
Effective Date	2016/07/01		Reviewer	

#### Hardware Box:

Hardware Box
<b>Part</b>
Wrench
Nylon Guide
19mm screws for Nylon Guide
Support L Bracket (based on the length of header)
63mm screws for support L bracket
19mm screws for support L bracket

#### The 2016 Stopper

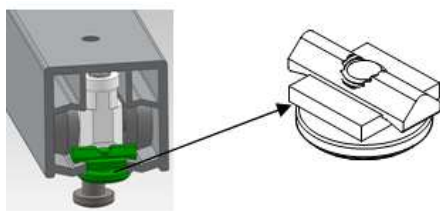

For outside mount/semi-inside mount bypass without side boards but with fascia returns, the 2016 Stopper will be supplied by default. The gap between the fascia return and the panel is 5mm each side. The 2016 stopper can also be used in the center or any position of the top track as an option.

Please see drawing below to show the gap.

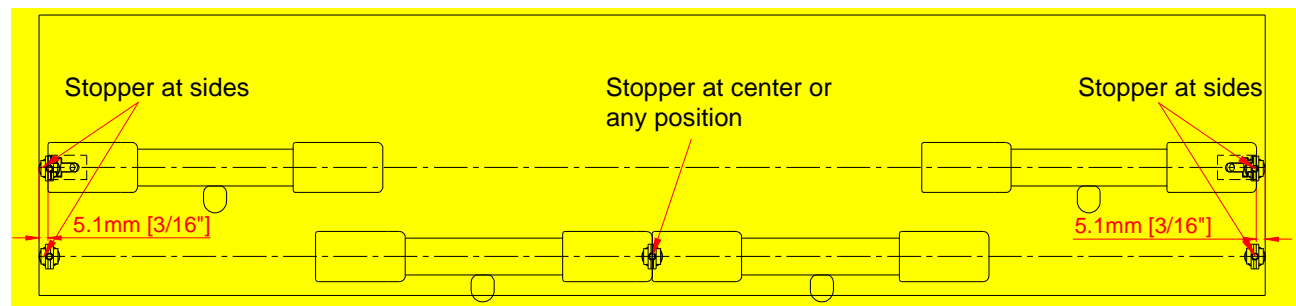

Blindtex Custom Shutter Specification				
Code	EM-021	2014 Bypass	Page	15 / 15
Edition	H		Compiler	
Effective Date	2016/07/01		Reviewer	

**The Claim Limitation Date for Shipping Damage for Airfreight Orders:**

For all airfreight orders with shipping damages, claims must be submitted within 2 weeks after the date of receipt.